

REGIONAL REVIEW FINDING

Atlanta Regional Commission • 229 Peachtree Street NE | Suite 100 | Atlanta, Georgia 30303 • ph: 404.463.3100 fax: 404.463.3205 • atlantaregional.org

DATE: May 8, 2018

ARC REVIEW CODE: R1804161

TO: Mayor John Ernst, City of Brookhaven
ATTN TO: Patrice Ruffin, Community Development Director
FROM: Douglas R. Hooker, Executive Director, ARC
RE: Development of Regional Impact (DRI) Review

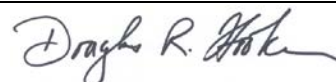

Digital signature
Original on file

The Atlanta Regional Commission (ARC) has completed a regional review of the following Development of Regional Impact (DRI). ARC reviewed the DRI with regard to its relationship to regional plans, goals and policies – and impacts it may have on the activities, plans, goals and policies of other local jurisdictions as well as state, federal and other agencies. This final report does not address whether the DRI is or is not in the best interest of the host local government.

Name of Proposal: Children's Healthcare of Atlanta Master Plan (DRI 2789)

Submitting Local Government: City of Brookhaven

Review Type: Development of Regional Impact **Date Opened:** April 16, 2018 **Date Closed:** May 7, 2018

Description: This DRI is in the City of Brookhaven, centered around present-day Tullie Circle and Tullie Road and adjacent to North Druid Hills Road (SR 42), the northbound I-85 Frontage Road, Cliff Valley Way, and Briarcliff Road. The project is proposed as a master-planned healthcare campus consisting of a 576-bed hospital, 608,000 SF of office space, 789,233 SF of medical office space, 50,000 SF of retail space, and a 150-room hotel. The development is proposed to ultimately replace the existing Children's Healthcare of Atlanta (CHOA) Egleston campus on Clifton Road, and the CHOA administrative offices currently on-site. The local trigger for this DRI review is a permit application filed with the City of Brookhaven. The estimated build-out year 2031.

Comments: According to the ARC Unified Growth Policy Map (UGPM), part of The Atlanta Region's Plan, this DRI is located in a Regional Employment Corridor as well as a Community Activity Center. ARC's Regional Development Guide (RDG) details recommended policies for areas on the UGPM. General information and policy recommendations for Regional Employment Corridors and Community Activity Centers are listed at the bottom of this report.

This DRI appears to implement certain aspects of regional policy. It converts a single-use office complex to an infill, mixed-use redevelopment with significant employment components, in relatively close proximity to MARTA bus service (routes 8, 16, 33 and 47). The project also proposes multi-use paths throughout the site for bike/pedestrian circulation, as well as multi-use paths on the North Druid Hills Road, I-85 Frontage Road and Briarcliff Road site frontages.

Many of these characteristics will collectively offer the potential for CHOA staff and visitors to park once or arrive via alternative transportation modes and conduct multiple trips on-site without the use of a car. Along those lines, care should be taken to ensure that the development promotes a functional, safe, clearly marked and comfortable pedestrian experience on all streets, paths and parking areas. The development team is also encouraged to ensure that end-of-trip facilities, e.g., bicycle racks, etc., are provided for workers and visitors at key locations throughout the site. In general, the project provides significant pedestrian facilities. The project can further support The Atlanta Region's Plan in general by incorporating other aspects of regional policy, including green infrastructure and/or low-impact design, e.g., rain gardens, vegetated swales, etc., in parking areas and site driveways, and as part of any improvements to site frontages.

The intensity of this proposed project generally aligns with the RDG's recommended range of densities and building heights in Regional Employment Corridors. However, some areas around this site are predominated by residential uses, including properties outside the City of Brookhaven, including unincorporated DeKalb County. City leadership and staff, along with the development team, should therefore collaborate to ensure maximum sensitivity to nearby neighborhoods, land uses and natural resources.

The transportation analysis for this DRI, required by the Georgia Regional Transportation Authority (GRTA) as part of its review and prepared by Kimley-Horn and Associates, analyzes not only a standard 2031 "Build" scenario but also a 2031 "Build Alternative" scenario. The alternative scenario includes nearly all of the improvements from the standard scenario, plus a Diverging Diamond Interchange (DDI) at I-85 and North Druid Hills Road, and the relocation of the intersection of North Druid Hills Road and Executive Park Drive/Tullie Road (Driveway #1 on the DRI site plan) approximately 500 feet south of its current location. The recommendations in the alternative scenario appear to show improvement, beyond that of the standard scenario, in future Levels of Service (LOS) and signal coordination, and would reduce future queueing in the area, including on I-85. These improvements are not fully funded/programmed at the time of this review and would require extensive, long-term coordination with, and cooperation from, a range of agencies and property owners. Therefore, they were not assumed in the standard Build scenario or on the DRI site plan as being implemented. ARC staff are available if needed to assist with or participate in future coordination, begun with the DRI review, between the City of Brookhaven, DeKalb County, GDOT and GRTA.

Additional ARC staff comments, regarding water resources and transportation, are included in this report, along with external comments received during the review period.

Further to the above, Regional Employment Corridors, along with the Region Core (Downtown, Midtown and Buckhead), form the densest part of the Atlanta region. Connected with transit, this area of the region is typically the most walkable, and redevelopment is the main driver of its growth. The Region Core and Regional Employment Corridors together contain 26 percent of the 10-county region's jobs and eight percent of region's population on approximately 2.25 percent of the region's land area. Regional policy recommendations for Regional Employment Corridors include:

- Continue to invest in the LCI program to assist local governments in center planning and infrastructure.
- Prioritize preservation of existing transit, increase frequency and availability of transit options.
- Encourage compact infill development, redevelopment and adaptive reuse.
- Create a range of housing options to accommodate all sectors of the workforce.
- Encourage active ground floor, pedestrian scale design, and pedestrian amenities in new development and the redevelopment of existing sites

Further to the above, Community Activity Centers serve a function similar to Regional Centers, on a smaller scale. People travel from the surrounding community to these centers for jobs, shopping and entertainment. These centers should be connected to the regional transportation network with existing or planned transit service. In many cases, these centers have high concentrations of commercial or retail space, and local plans call for infill development or redevelopment. These places have the potential to emerge as Regional Centers in the future. Local plans and policies should support efforts to transform these places into accessible, mixed-use centers. Regional policy recommendations for Community Activity Centers include:

- Prioritize preservation, expansion, and access to existing and planned transit systems and improve the quality and aesthetics of existing facilities
- Incorporate appropriate end-of-trip facilities, such as bicycle racks, showers/locker rooms, etc, within new and existing development
- Enhance mobility and accessibility for all by creating Complete Streets that accommodate all modes of transportation
- Encourage active ground floor, pedestrian scale design, and pedestrian amenities in new development and redevelopment of existing sites
- Work toward improving the jobs-housing imbalance in Regional Centers and promote housing options to accommodate multiple household sizes and price points in close proximity to jobs
- Use alternative designs and materials to minimize impervious surfaces to the greatest possible extent

THE FOLLOWING LOCAL GOVERNMENTS AND AGENCIES RECEIVED NOTICE OF THIS REVIEW:

ARC COMMUNITY DEVELOPMENT
ARC RESEARCH & ANALYTICS
GEORGIA DEPARTMENT OF NATURAL RESOURCES
METROPOLITAN ATLANTA RAPID TRANSIT AUTHORITY
CITY OF CHAMBLEE

ARC TRANSPORTATION ACCESS & MOBILITY
ARC AGING & INDEPENDENCE SERVICES
GEORGIA DEPARTMENT OF TRANSPORTATION
DEKALB COUNTY
CITY OF DECATUR

ARC NATURAL RESOURCES
GEORGIA DEPARTMENT OF COMMUNITY AFFAIRS
GEORGIA REGIONAL TRANSPORTATION AUTHORITY
CITY OF ATLANTA
CITY OF TUCKER

If you have any questions regarding this review, please contact Andrew Smith at (470) 378-1645 or asmith@atlantaregional.org. This finding will be published to the ARC review website located at <http://atlantaregional.org/plan-reviews>.

Andrew Smith

From: McLoyd, Johnathan G <JoMcLoyd@dot.ga.gov>
Sent: Thursday, April 26, 2018 9:31 AM
To: Andrew Smith
Cc: Peevy, Phillip M.; Robinson, Charles A.; DeNard, Paul
Subject: RE: ARC DRI Review Notification: Children's Healthcare of Atlanta Master Plan (DRI 2789)

Good Afternoon Andrew,

The GDOT Office of Planning has reviewed the Children's Healthcare of Atlanta Master Plan (DRI 2789) Preliminary report, and there is one (1) GDOT project in addition to those already mentioned in the preliminary report:

- o GDOT Project Identification No. (PI No.) 0015919 – I-85 NB FROM SR 42 TO SR 155– Operational Improvement, CST FY 2020 – The GDOT Project Manager for this project is Lindsay Atnip and can be reached at 678-802-1101 or Lindsay.Atnip@dot.state.ga.us.

For further information that may be needed concerning this review, please contact Johnathan G. McLoyd at 404-631-1774 or JoMcLoyd@dot.ga.gov.

Thank you,

Johnathan G. McLoyd

From: Andrew Smith [<mailto:ASmith@atlantaregional.org>]
Sent: Monday, April 16, 2018 4:58 PM
To: VanDyke, Cindy; Fowler, Matthew; Matthews, Timothy W; Garth Lynch; Wayne Mote (wmote@HNTB.com); Peevy, Phillip M.; Robinson, Charles A.; Weiss, Megan J; Delgadillo Canizares, Marlene V.; Comer, Carol; Hood, Alan C.; Zahul, Kathy; DeNard, Paul; Regis, Edlin; Woods, Chris N.; Johnson, Lankston; Boone, Eric; Annie Gillespie; Emily Estes; Parker Martin; 'DRI@grta.org'; 'Jon West'; chuck.mueller@dnr.state.ga.us; Greg Floyd (gffloyd@itsmarta.com); Sidifall, Janide; Forte, Monique B.; dpced-jdowdy@atlantaga.gov; Morgan, Jason; Washington, James; Kedir, Nursef; Charletta Wilson Jacks (cjacks@atlantaga.gov); Jessica Lavandier (jlavandier@atlantaga.gov); colteanu@atlantaga.gov; mdickison@chambleega.gov; tbaxter@chambleega.gov; rkeefe@chambleega.gov; Andrew Baker (aabaker@co.dekalb.ga.us); Hudson, Cedric (chudson@dekalbcountyga.gov); Brian Brewer; Washington, Larry; Eisenberg, Marian; Furman, Melora L.; pgkeeter@dekalbcountyga.gov; 'sasmith@dekalbcountyga.gov'; lyn.menne@decaturga.com; angela.threadgill@decaturga.com; John.Maximuk@decaturga.com; jmchenry@tuckerga.gov; Courtney Lankford; Patrice Ruffin (patrice.ruffin@brookhavenga.gov); linda.abaray@brookhavenga.gov; Hari Karikaran; Kevin Korth; David R. Tatum (david.tatum@choa.org); Chelette, Christopher; travis.spankowski@choa.org; Woody Galloway; laurel@glawgp.com; Rob.Ross@kimley-horn.com; Johnson, Elizabeth
Cc: Community Development; Mike Alexander; David Haynes; Marquitrice Mangham; Ryan Ellis; Jim Santo; Jim Skinner; Katie Perumbeti; Paul Donsky
Subject: ARC DRI Review Notification: Children's Healthcare of Atlanta Master Plan (DRI 2789)

CAUTION: This email originated from outside of the organization. Do not click links or open attachments unless you recognize the sender and know the content is safe.

Development of Regional Impact (DRI) – Request for Comments

This e-mail serves as notice that the Atlanta Regional Commission (ARC) has begun a Development of Regional Impact (DRI) review for Children's Healthcare of Atlanta Master Plan (DRI 2789).

This DRI is in the City of Brookhaven, centered around present-day Tullie Circle and Tullie Road and adjacent to North Druid Hills Road (SR 42), the northbound I-85 Frontage Road, Cliff Valley Way, and Briarcliff Road. The project is proposed as a master-planned healthcare campus consisting of a 576-bed hospital, 608,000 SF of office space, 789,233 SF of medical office space, 50,000 SF of retail space, and a 150-room hotel. The development is proposed to ultimately replace the existing Children's Healthcare of Atlanta (CHOA) Egleston campus on Clifton Road, and the CHOA administrative offices currently on-site. The local trigger for this DRI review is a permit application filed with the City of Brookhaven. The estimated build-out year 2031.

As a representative of a nearby local government or other potentially affected party, we request that you or your staff review the attached ARC Preliminary Report and provide any comments on the DRI to ARC on or before **May 1, 2018**.

You may also view the Preliminary Report and other project information by visiting the [ARC Plan Reviews webpage](#) beginning tomorrow, April 17, and entering "Children's Healthcare of Atlanta Master Plan" in the search field at the bottom of the page.

Comments may be directed to me via email to asmith@atlantaregional.org or via U.S. mail to the address noted in my signature below.

For more information regarding the DRI process, please visit the [ARC DRI webpage](#).

Regards,

Andrew Smith

Principal Planner, Community Development

Atlanta Regional Commission

P | 470.378.1645

asmith@atlantaregional.org

atlantaregional.org

International Tower

229 Peachtree Street NE | Suite 100

Atlanta, Georgia 30303

There's road work ahead. And roadway work zones are hazardous for workers and the public. In fact, most victims in work zone crashes are drivers or passengers. Work zone safety is everybody's responsibility - pay attention – slow down – watch for workers - expect the unexpected. And whenever you drive, always **Drive Alert Arrive Alive** - buckle up; stay off the phone and no texting. Visit www.dot.ga.gov.

Andrew Smith

From: Hood, Alan C. <achood@dot.ga.gov>
Sent: Friday, April 27, 2018 2:53 PM
To: Andrew Smith
Cc: Brian, Steve; Comer, Carol; Edmisten, Colette; Kleine, Tracie; maevans@dekalbcountyga.gov
Subject: RE: ARC DRI Review Notification: Children's Healthcare of Atlanta Master Plan (DRI 2789)
Attachments: ARC Preliminary Report - Childrens Healthcare of Atlanta Master Plan - DRI 2789.pdf

Andrew,

The project is proposed as a master-planned healthcare campus consisting of a 576-bed hospital, 608,000 SF of office space, 789,233 SF of medical office space, 50,000 SF of retail space, and a 150-room hotel. The development is proposed to ultimately replace the existing Children's Healthcare of Atlanta (CHOA) Egleston campus on Clifton Road, and the CHOA administrative offices currently on-site. It is located approximately 3 miles south west of DeKalb-Peachtree Airport (PDK), and is located outside any of their FAA approach or departure surfaces, and compatible land use areas, and does not appear to impact the airport.

However the proposed structure is in proximity to a navigation facility and may impact the assurance of navigation signal reception. Cases have already been submitted for these buildings and are currently being reviewed.

I have copied Mario Evans with DeKalb-Peachtree Airport (PDK) on this email.

Thank you for the opportunity to comment on the proposed development.

Alan Hood | Airport Safety Data Program Manager
Georgia Department of Transportation - Aviation Programs
600 West Peachtree Street, N.W. | 2nd Floor | Atlanta, Georgia 30308
M: 404-660-3394 | F: 404-631-1935 | | E: achood@dot.ga.gov

View our website at <http://www.dot.ga.gov/IS/AirportAid>

From: Andrew Smith [mailto:ASmith@atlantaregional.org]
Sent: Monday, April 16, 2018 4:58 PM
To: VanDyke, Cindy <cyvandyke@dot.ga.gov>; Fowler, Matthew <mfowler@dot.ga.gov>; Matthews, Timothy W <TMatthews@dot.ga.gov>; Garth Lynch <glynch@HNTB.com>; Wayne Mote (wmote@HNTB.com) <wmote@HNTB.com>; Peevy, Phillip M. <PPeevy@dot.ga.gov>; Robinson, Charles A. <chrobinson@dot.ga.gov>; Weiss, Megan J <MWeiss@dot.ga.gov>; Delgadillo Canizares, Marlene V. <mcanizares@dot.ga.gov>; Comer, Carol <ccomer@dot.ga.gov>; Hood, Alan C. <achood@dot.ga.gov>; Zahul, Kathy <kzahul@dot.ga.gov>; DeNard, Paul <pdenard@dot.ga.gov>; Regis, Edlin <eregis@dot.ga.gov>; Woods, Chris N. <cwoods@dot.ga.gov>; Johnson, Lankston <lajohnson@dot.ga.gov>; Boone, Eric <eboone@dot.ga.gov>; Annie Gillespie <agillespie@srta.ga.gov>; Emily Estes <eestes@srta.ga.gov>; Parker Martin <PMartin@srta.ga.gov>; 'DRI@grta.org' <DRI@grta.org>; 'Jon West' <jon.west@dca.ga.gov>; chuck.mueller@dnr.state.ga.us; Greg Floyd (gfloyd@itsmarta.com) <gfloyd@itsmarta.com>; Sidifall, Janide <jsidifall@AtlantaGa.Gov>; Forte, Monique B. <MBForte@AtlantaGa.Gov>; dpdc-jdowdy@atlantaga.gov; Morgan, Jason <JMorgan@AtlantaGa.Gov>; Washington, James <JWashington@AtlantaGa.Gov>; Kadir, Nursef <nkadir@AtlantaGa.Gov>; Charletta Wilson Jacks (cjacks@atlantaga.gov) <cjacks@atlantaga.gov>; Jessica Lavandier (jlavandier@atlantaga.gov) <jlavandier@atlantaga.gov>; colteanu@atlantaga.gov; mdickison@chambleega.gov; tbaxter@chambleega.gov; rkeefe@chambleega.gov; Andrew Baker (aabaker@co.dekalb.ga.us) <aabaker@co.dekalb.ga.us>; Hudson, Cedric (chudson@dekalbcountyga.gov) <chudson@dekalbcountyga.gov>; Brian Brewer <bnbrewer@dekalbcountyga.gov>; Washington, Larry <lWASHINGTON@dekalbcountyga.gov>; Eisenberg, Marian

<meisenberg@dekalbcountyga.gov>; Furman, Melora L. <mlfurman@dekalbcountyga.gov>;
pgkeeter@dekalbcountyga.gov; 'sasmith@dekalbcountyga.gov' <sasmith@dekalbcountyga.gov>;
lyn.menne@decaturga.com; angela.threadgill@decaturga.com; John.Maximuk@decaturga.com;
jmchenry@tuckerga.gov; Courtney Lankford <clankford@tuckerga.gov>; Patrice Ruffin
(patrice.ruffin@brookhavenga.gov) <patrice.ruffin@brookhavenga.gov>; linda.abaray@brookhavenga.gov; Hari
Karikaran <hari.karikaran@brookhavenga.gov>; Kevin Korth <kevin.korth@brookhavenga.gov>; David R. Tatum
(david.tatum@choa.org) <david.tatum@choa.org>; Chelette, Christopher <Christopher.Chelette@choa.org>;
travis.spankowski@choa.org; Woody Galloway <woody@glawgp.com>; laurel@glawgp.com; Rob.Ross@kimley-
horn.com; Johnson, Elizabeth <elizabeth.johnson@kimley-horn.com>

Cc: Community Development <CommunityDevelopment@atlantaregional.org>; Mike Alexander
<MAlexander@atlantaregional.org>; David Haynes <DHaynes@atlantaregional.org>; Marquitrice Mangham
<MMangham@atlantaregional.org>; Ryan Ellis <REllis@atlantaregional.org>; Jim Santo <JSanto@atlantaregional.org>;
Jim Skinner <JSkinner@atlantaregional.org>; Katie Perumbeti <KPerumbeti@atlantaregional.org>; Paul Donsky
<PDonsky@atlantaregional.org>

Subject: ARC DRI Review Notification: Children's Healthcare of Atlanta Master Plan (DRI 2789)

CAUTION: This email originated from outside of the organization. Do not click links or open attachments unless you recognize the sender and know the content is safe.

Development of Regional Impact (DRI) – Request for Comments

This e-mail serves as notice that the Atlanta Regional Commission (ARC) has begun a Development of Regional Impact (DRI) review for **Children's Healthcare of Atlanta Master Plan (DRI 2789)**.

This DRI is in the City of Brookhaven, centered around present-day Tullie Circle and Tullie Road and adjacent to North Druid Hills Road (SR 42), the northbound I-85 Frontage Road, Cliff Valley Way, and Briarcliff Road. The project is proposed as a master-planned healthcare campus consisting of a 576-bed hospital, 608,000 SF of office space, 789,233 SF of medical office space, 50,000 SF of retail space, and a 150-room hotel. The development is proposed to ultimately replace the existing Children's Healthcare of Atlanta (CHOA) Egleston campus on Clifton Road, and the CHOA administrative offices currently on-site. The local trigger for this DRI review is a permit application filed with the City of Brookhaven. The estimated build-out year 2031.

As a representative of a nearby local government or other potentially affected party, we request that you or your staff review the attached ARC Preliminary Report and provide any comments on the DRI to ARC on or before **May 1, 2018**.

You may also view the Preliminary Report and other project information by visiting the [ARC Plan Reviews webpage](#) beginning tomorrow, April 17, and entering "Children's Healthcare of Atlanta Master Plan" in the search field at the bottom of the page.

Comments may be directed to me via email to asmith@atlantaregional.org or via U.S. mail to the address noted in my signature below.

For more information regarding the DRI process, please visit the [ARC DRI webpage](#).

Regards,

Andrew Smith

Principal Planner, Community Development

Atlanta Regional Commission

P | 470.378.1645

asmith@atlantaregional.org

atlantaregional.org

International Tower

There's road work ahead. And roadway work zones are hazardous for workers and the public. In fact, most victims in work zone crashes are drivers or passengers. Work zone safety is everybody's responsibility - pay attention – slow down – watch for workers - expect the unexpected. And whenever you drive, always **Drive Alert Arrive Alive** - buckle up; stay off the phone and no texting. Visit www.dot.ga.gov.

Andrew Smith

From: Kevin Korth <kevin.korth@brookhavenga.gov>
Sent: Tuesday, May 1, 2018 5:18 PM
To: Andrew Smith
Cc: Patrice Ruffin; Linda Abaray; Hari Karikaran
Subject: RE: ARC DRI Review Notification: Children's Healthcare of Atlanta Master Plan (DRI 2789)

The City of Brookhaven has reviewed the ARC Preliminary Report provided April 16th and have no comments.



Kevin Korth, P.E.

Transportation Engineer
Public Works-Traffic Engineering
City of Brookhaven

☎ 404-637-0724

kevin.korth@brookhavenga.gov

<http://www.brookhavenga.gov/city-departments/public-works>

4362 Peachtree Rd. | Brookhaven, GA | 30319

This e-mail message (including any attachments) is for the sole use of the intended recipient(s) and may contain confidential and privileged information. If you have received this message in error, please contact the sender and destroy all copies of the original message (including attachments). The City of Brookhaven is a public entity subject to the Official Code of Georgia Annotated §§ 50-18-70 to 50-18-76 concerning public records

From: Andrew Smith <ASmith@atlantaregional.org>

Sent: Monday, April 16, 2018 4:58 PM

To: 'cyvandyke@dot.ga.gov' <cyvandyke@dot.ga.gov>; Fowler, Matthew <mfowler@dot.ga.gov>; Matthews, Timothy W <TMatthews@dot.ga.gov>; Garth Lynch <glynch@HNTB.com>; Wayne Mote (wmote@HNTB.com) <wmote@HNTB.com>; PPeavy@dot.ga.gov; Robinson, Charles A. <chrobinson@dot.ga.gov>; Weiss, Megan J <MWeiss@dot.ga.gov>; Delgadillo Canizares, Marlene V. <mcanizares@dot.ga.gov>; 'ccomer@dot.ga.gov' <ccomer@dot.ga.gov>; Hood, Alan C. (achood@dot.ga.gov) <achood@dot.ga.gov>; Kathy Zahul (kzahul@dot.ga.gov) <kzahul@dot.ga.gov>; DeNard, Paul <pdenard@dot.ga.gov>; Regis, Edlin <eregis@dot.ga.gov>; Woods, Chris N. <cwoods@dot.ga.gov>; Johnson, Lankston <lajohnson@dot.ga.gov>; Boone, Eric <eboone@dot.ga.gov>; Annie Gillespie <agillespie@srta.ga.gov>; Emily Estes <eestes@srta.ga.gov>; Parker Martin <PMartin@srta.ga.gov>; 'DRI@grta.org' <DRI@grta.org>; 'Jon West' <jon.west@dca.ga.gov>; chuck.mueller@dnr.state.ga.us; Greg Floyd (gfloyd@itsmarta.com) <gfloyd@itsmarta.com>; Sidifall, Janide <jsidifall@AtlantaGa.Gov>; Forte, Monique B. <MBForte@AtlantaGa.Gov>; dpdc-jdowdy@atlantaga.gov; Morgan, Jason <JMorgan@AtlantaGa.Gov>; Washington, James <JWashington@AtlantaGa.Gov>; Kedir, Nursef <nkedir@AtlantaGa.Gov>; Charletta Wilson Jacks (cjacks@atlantaga.gov) <cjacks@atlantaga.gov>; Jessica Lavandier (jlavandier@atlantaga.gov) <jlavandier@atlantaga.gov>; colteanu@atlantaga.gov; mdickison@chambleega.gov; tbaxter@chambleega.gov; rkeefe@chambleega.gov; Andrew Baker (aabaker@co.dekalb.ga.us) <aabaker@co.dekalb.ga.us>; Hudson, Cedric (chudson@dekalbcountyga.gov) <chudson@dekalbcountyga.gov>; Brian Brewer <bnbrewer@dekalbcountyga.gov>; Washington, Larry <lWASHINGTON@dekalbcountyga.gov>; Eisenberg, Marian <meisenberg@dekalbcountyga.gov>; Furman, Melora L. <mlfurman@dekalbcountyga.gov>; pgkeeter@dekalbcountyga.gov; 'sasmith@dekalbcountyga.gov' <sasmith@dekalbcountyga.gov>; lyn.menne@decaturga.com; angela.threadgill@decaturga.com; John.Maximuk@decaturga.com; jmchenry@tuckerga.gov; Courtney Lankford <clankford@tuckerga.gov>; Patrice Ruffin <patrice.ruffin@brookhavenga.gov>; Linda Abaray <linda.abaray@brookhavenga.gov>; Hari Karikaran <hari.karikaran@brookhavenga.gov>; Kevin Korth <kevin.korth@brookhavenga.gov>; David R. Tatum (david.tatum@choa.org) <david.tatum@choa.org>; Chelette, Christopher <Christopher.Chelette@choa.org>; travis.spankowski@choa.org; Woody Galloway <woody@glawgp.com>; laurel@glawgp.com; Rob.Ross@kimley-

horn.com; Johnson, Elizabeth <elizabeth.johnson@kimley-horn.com>

Cc: Community Development <CommunityDevelopment@atlantaregional.org>; Mike Alexander <MAlexander@atlantaregional.org>; David Haynes <DHaynes@atlantaregional.org>; Marquitrice Mangham <MMangham@atlantaregional.org>; Ryan Ellis <REllis@atlantaregional.org>; Jim Santo <JSanto@atlantaregional.org>; Jim Skinner <JSkinner@atlantaregional.org>; Katie Perumbeti <KPerumbeti@atlantaregional.org>; Paul Donsky <PDonsky@atlantaregional.org>

Subject: ARC DRI Review Notification: Children's Healthcare of Atlanta Master Plan (DRI 2789)

Development of Regional Impact (DRI) – Request for Comments

This e-mail serves as notice that the Atlanta Regional Commission (ARC) has begun a Development of Regional Impact (DRI) review for **Children's Healthcare of Atlanta Master Plan (DRI 2789)**.

This DRI is in the City of Brookhaven, centered around present-day Tullie Circle and Tullie Road and adjacent to North Druid Hills Road (SR 42), the northbound I-85 Frontage Road, Cliff Valley Way, and Briarcliff Road. The project is proposed as a master-planned healthcare campus consisting of a 576-bed hospital, 608,000 SF of office space, 789,233 SF of medical office space, 50,000 SF of retail space, and a 150-room hotel. The development is proposed to ultimately replace the existing Children's Healthcare of Atlanta (CHOA) Egleston campus on Clifton Road, and the CHOA administrative offices currently on-site. The local trigger for this DRI review is a permit application filed with the City of Brookhaven. The estimated build-out year 2031.

As a representative of a nearby local government or other potentially affected party, we request that you or your staff review the attached ARC Preliminary Report and provide any comments on the DRI to ARC on or before **May 1, 2018**.

You may also view the Preliminary Report and other project information by visiting the [ARC Plan Reviews webpage](#) beginning tomorrow, April 17, and entering "Children's Healthcare of Atlanta Master Plan" in the search field at the bottom of the page.

Comments may be directed to me via email to asmith@atlantaregional.org or via U.S. mail to the address noted in my signature below.

For more information regarding the DRI process, please visit the [ARC DRI webpage](#).

Regards,

Andrew Smith

Principal Planner, Community Development

Atlanta Regional Commission

P | 470.378.1645

asmith@atlantaregional.org

atlantaregional.org

International Tower

229 Peachtree Street NE | Suite 100

Atlanta, Georgia 30303

CHILDREN'S HEALTHCARE OF ATLANTA MASTER PLAN DRI
City of Brookhaven
Natural Resources Group Review Comments
April 10, 2018

Watershed Protection and Stream Buffers

The proposed project is in the watershed of the North Fork of Peachtree Creek, which is part of the Peachtree Creek watershed that drains into the Chattahoochee River downstream of the water supply intakes in the Atlanta Region. The USGS coverage for the project area shows one blue line stream crossing the property in the northeastern corner near Cliff Valley Way. The stream is also shown, with buffers, on the submitted site plan. Both the State 25-foot and the City's 50- and 75-foot buffers are shown. The submitted plans show intrusions into the City buffers on both sides of the stream consisting of access driveways and a bridge crossing connecting a parking deck with the main campus. However, based on aerial photo evidence, the intrusions may be over or near existing impervious areas on the already developed site. Work in these areas will be subject to the requirements of the City of Brookhaven Stream Buffer Ordinance. The need for variances will depend on the ordinance language and the scope of the proposed land disturbance and impervious surface in and near the buffers. Any intrusions into the State 25-foot Erosion and Sedimentation Buffer may also require variances. Any unmapped waters of the state on the property will also be subject to the State 25-foot erosion and sedimentation buffer.

Stormwater / Water Quality

The project should adequately address the impacts of the proposed development on stormwater runoff and downstream water quality. During construction, the project should conform to the relevant state and federal erosion and sedimentation control requirements. After construction, water quality will be impacted due to polluted stormwater runoff. The amount of pollutants that will be produced after construction of the proposed development are dependent on the type and intensity of the use and the impervious coverage, which will affect the design of stormwater controls for the project.

In order to address post-construction stormwater runoff quality, the project should implement stormwater management controls (structural and/or nonstructural) as found in the Georgia Stormwater Management Manual (www.georgiastormwater.com) and meet the stormwater management quantity and quality criteria outlined in the Manual. Where possible, the project should utilize the stormwater better site design concepts included in the Manual.

We also suggest the following additional measures to help reduce stormwater reduction and provide for its reuse:

- Use green spaces and tree planting beds as stormwater controls. These can be designed to provide maximum aesthetic value while also providing for water quality treatment and run-off reduction, potentially reducing the need for larger stormwater facilities and helping to minimize the negative effects of stormwater runoff on streams and water quality.
- Use pervious concrete or other pervious materials in the parking/storage areas. With the proper substrate, such materials can provide a large storage capacity, which will further help to reduce stormwater runoff and can help filter pollutants before reaching streams.
- Include rainwater capture in the project design to provide for landscape irrigation during dry periods.

Development of Regional Impact Assessment of Consistency with the Regional Transportation Plan

DRI INFORMATION

DRI Number #2789
DRI Title Children's Healthcare of Atlanta
County DeKalb County
City (if applicable) City of Brookhaven
Address / Location The site is located north of Briarcliff Road, south of Interstate 85, east of North Druid Hills Road and west of Cliff Valley Way.

Proposed Development Type:

A 72-acre medical office complex with an additional 576 hospital beds, 150 room hotel, 608,000 sf of general office, 789,233 sf of medical office and 50,000 sf of retail.

Review Process ☐ EXPEDITED
☒ NON-EXPEDITED

REVIEW INFORMATION

Prepared by ARC Transportation Access and Mobility Division
Staff Lead Marquitrice Mangham
Copied [Click here to enter text.](#)
Date April 11, 2018

TRAFFIC STUDY

Prepared by Kimley Horn
Date April 2, 2018

REGIONAL TRANSPORTATION PLAN PROJECTS

- 01. Did the traffic analysis incorporate all projects contained in the current version of the fiscally constrained RTP which are within the study area or along major transportation corridors connecting the study area with adjacent jurisdictions?**

☒ YES *(provide the regional plan referenced and the page number of the traffic study where relevant projects are identified)*

The traffic analysis includes Appendix E of project fact sheets in the network study area and a chart of programmed projects as identified in the Atlanta Region's Plan on Page 42 of the traffic analysis.

☐ NO *(provide comments below)*

REGIONAL NETWORKS

- 02. Will the development site be directly served by any roadways identified as Regional Thoroughfares?**

A Regional Thoroughfare is a major transportation corridor that serves multiple ways of traveling, including walking, bicycling, driving, and riding transit. It connects people and goods to important places in metropolitan Atlanta. A Regional Thoroughfare's operations should be managed through application of special traffic control strategies and suitable land development guidelines in order to maintain travel efficiency, reliability, and safety for all users. In light of the special function that Regional Thoroughfares serve in supporting cross-regional and interjurisdictional mobility and access, the network receives priority consideration for infrastructure investment in the Metro Atlanta region. Any access points between the development and a Regional Thoroughfare, combined with the development's on-site circulation patterns, must be designed with the goal of preserving the highest possible level of capacity and safety for all users of the roadway.

☐ NO

☒ YES *(identify the roadways and existing/proposed access points)*

The development proposes access off Briarcliff Road, North Druid Hills Road and the I-85 access road. Briarcliff Road also known as SR 42 is a regional thoroughfare.

03. Will the development site be directly served by any roadways identified as Regional Truck Routes?

A Regional Truck Route is a freeway, state route or other roadway which serves as a critical link for the movement of goods to, from and within the Region by connecting airports, intermodal/multimodal facilities, distribution and warehousing centers and manufacturing clusters with the rest of the state and nation. These facilities often serve a key mobility and access function for other users as well, including drivers, bicyclists, pedestrians and transit users. A Regional Truck Route's operations should be managed through application of special traffic control strategies and suitable land development guidelines in order to maintain travel efficiency, reliability, and safety for all users. In light of the special function that Regional Truck Routes serve in supporting cross-regional and interjurisdictional mobility and access, the network receives priority consideration for infrastructure investment in the Metro Atlanta region. Any access points between the development and a Regional Truck Route, combined with the development's on-site circulation patterns, must be designed with the goal of preserving the highest possible level of capacity and safety for all users of the roadway.

☒ NO

☐ YES (*identify the roadways and existing/proposed access points*)

[Click here to provide comments.](#)

04. If the development site is within one mile of an existing rail service, provide information on accessibility conditions.

Access between major developments and transit services provide options for people who cannot or prefer not to drive, expand economic opportunities by better connecting people and jobs, and can help reduce congestion. If a transit service is available nearby, but walking or bicycling between the development site and the nearest station is a challenge, the applicable local government(s) is encouraged to make the route a funding priority for future walking and bicycling infrastructure improvements.

☒ NOT APPLICABLE (*nearest station more than one mile away*)

☐ RAIL SERVICE WITHIN ONE MILE (*provide additional information below*)

Operator / Rail Line

Nearest Station North Avenue Rail station is 1.2 miles away from the site.

Distance* ☐ Within or adjacent to the development site (0.10 mile or less)
☐ 0.10 to 0.50 mile
☐ 0.50 to 1.00 mile

Walking Access* ☐ Sidewalks and crosswalks provide sufficient connectivity
☐ Sidewalk and crosswalk network is incomplete
☐ Not applicable (*accessing the site by walking is not consistent with the type of development proposed*)

[Click here to provide comments.](#)

Bicycling Access*

- ☐ Dedicated paths, lanes or cycle tracks provide sufficient connectivity
- ☐ Low volume and/or low speed streets provide connectivity
- ☐ Route follows high volume and/or high speed streets
- ☐ Not applicable (*accessing the site by bicycling is not consistent with the type of development proposed*)

Transit Connectivity

- ☐ Fixed route transit agency bus service available to rail station
- ☐ Private shuttle or circulator available to rail station
- ☐ No services available to rail station
- ☐ Not applicable (*accessing the site by transit is not consistent with the type of development proposed*)

[Click here to provide comments.](#)

** Following the most direct feasible walking or bicycling route to the nearest point on the development site*

05. If there is currently no rail transit service within one mile of the development site, is nearby rail service planned in the fiscally constrained RTP?

Access between major developments and transit services provide options for people who cannot or prefer not to drive, expand economic opportunities by better connecting people and jobs, and can help reduce traffic congestion. If a transit agency operates within the jurisdiction and expansion plans are being considered in the general vicinity of the development site, the agency should give consideration to how the site can be best served during the evaluation of alignments and station locations. Proactive negotiations with the development team and local government(s) are encouraged to determine whether right-of-way within the site should be identified and protected for potential future service. If direct service to the site is not feasible or cost effective, the transit agency and local government(s) are encouraged to ensure good walking and bicycling access accessibility is provided between the development and the future rail line. These improvements should be considered fundamental components of the overall transit expansion project, with improvements completed concurrent with or prior to the transit service being brought online.

- ☐ NOT APPLICABLE (rail service already exists)
- ☐ NOT APPLICABLE (accessing the site by transit is not consistent with the type of development proposed)
- ☒ NO (no plans exist to provide rail service in the general vicinity)
- ☐ YES (provide additional information on the timeframe of the expansion project below)
 - ☐ CST planned within TIP period
 - ☐ CST planned within first portion of long range period
 - ☐ CST planned near end of plan horizon

MARTA Rail Service does exist in the broader vicinity of the site. No rail service within one mile.

06. If the development site is within one mile of fixed route bus services (including any privately operated shuttles or circulators open to the general public), provide information on walking and bicycling accessibility conditions.

Access between major developments and transit services provide options for people who cannot or prefer not to drive, expand economic opportunities by better connecting people and jobs, and can help reduce congestion. If a transit service is available nearby, but walking or bicycling between the development site and the nearest station is a challenge, the applicable local government(s) is encouraged to make the connection a funding priority for future walking and bicycling infrastructure improvements.

☐ NOT APPLICABLE (nearest bus, shuttle or circulator stop more than one mile away)

☒ SERVICE WITHIN ONE MILE (provide additional information below)

Operator(s) MARTA

Bus Route(s) 16, 33, 8, and 47

Distance* ☒ Within or adjacent to the development site (0.10 mile or less)

☐ 0.10 to 0.50 mile

☐ 0.50 to 1.00 mile

Walking Access* ☒ Sidewalks and crosswalks provide sufficient connectivity

☐ Sidewalk and crosswalk network is incomplete

☐ Not applicable (accessing the site by walking is not consistent with the type of development proposed)

The site is directly adjacent to the Eastside Atlanta Beltline

Bicycling Access* ☐ Dedicated paths, lanes or cycle tracks provide sufficient connectivity

☒ Low volume and/or low speed streets provide sufficient connectivity

☐ Route uses high volume and/or high speed streets

☐ Not applicable (accessing the site by bicycling is not consistent with the type of development proposed)

* Following the most direct feasible walking or bicycling route to the nearest point on the development site

07. Does a transit agency which provides rail and/or fixed route bus service operate anywhere within the jurisdiction in which the development site is located?

Access between major developments and transit services provide options for people who cannot or prefer not to drive, expand economic opportunities by better connecting people and jobs, and can help reduce traffic congestion. If a transit agency operates within the jurisdiction and a comprehensive operations plan update is undertaken, the agency should give consideration to serving the site during the evaluation of future routes, bus stops and transfer facilities. If the nature of the development is amenable to access by transit, walking or bicycling, but direct service to the site is not feasible or cost effective, the transit agency and local government(s) should ensure good walking and bicycling access accessibility is provided between the development and any routes within a one mile radius. The applicable local government(s) is encouraged to make these connections a funding priority for future walking and bicycling infrastructure improvements.

☐ NO

☒ YES

08. If the development site is within one mile of an existing multi-use path or trail, provide information on accessibility conditions.

Access between major developments and walking/bicycling facilities provide options for people who cannot or prefer not to drive, expand economic opportunities by better connecting people and jobs, and can help reduce traffic congestion. If connectivity with a regionally significant path or trail is available nearby, but walking or bicycling between the development site and those facilities is a challenge, the applicable local government(s) is encouraged to make the route a funding priority for future walking and bicycling infrastructure improvements.

☐ NOT APPLICABLE (nearest path or trail more than one mile away)

☒ YES (provide additional information below)

Name of facility Peachtree Creek Greenway

Distance ☐ Within or adjacent to development site (0.10 mile or less)

☒ 0.15 to 0.50 mile

☐ 0.50 to 1.00 mile

Walking Access* ☒ Sidewalks and crosswalks provide connectivity

☐ Sidewalk and crosswalk network is incomplete

☐ Not applicable (accessing the site by walking is not consistent with the type of development proposed)

Bicycling Access* ☐ Dedicated lanes or cycle tracks provide connectivity

☒ Low volume and/or low speed streets provide connectivity

☐ Route uses high volume and/or high speed streets

☐ Not applicable (accessing the site by bicycling is not consistent with the type of development proposed)

* Following the most direct feasible walking or bicycling route to the nearest point on the development site

OTHER TRANSPORTATION DESIGN CONSIDERATIONS

09. Does the site plan provide for the construction of publicly accessible local road or drive aisle connections with adjacent parcels?

The ability for drivers and bus routes to move between developments without using the adjacent arterial or collector roadway networks can save time and reduce congestion. Such opportunities should be considered and proactively incorporated into development site plans whenever possible.

- ☐ YES (connections to adjacent parcels are planned as part of the development)
- ☐ YES (stub outs will make future connections possible when adjacent parcels redevelop)
- ☒ NO (the site plan precludes future connections with adjacent parcels when they redevelop)
- ☐ OTHER (Please explain)

Proposed driveways provide movement between used internal to the development however no vehicular access to adjacent parcels is planned.

10. Does the site plan enable pedestrians and bicyclists to move between destinations within the development site safely and conveniently?

The ability for walkers and bicyclists to move within the site safely and conveniently reduces reliance on vehicular trips, which has congestion reduction and health benefits. Development site plans should incorporate well designed and direct sidewalk connections between all key destinations. To the extent practical, bicycle lanes or multiuse paths are encouraged for large acreage sites and where high volumes of bicyclists and pedestrians are possible.

- ☒ YES (sidewalks provided on all key walking routes and both sides of roads whenever practical and bicyclists should have no major issues navigating the street network)
- ☐ PARTIAL (some walking and bicycling facilities are provided, but connections are not comprehensive and/or direct)
- ☐ NO (walking and bicycling facilities within the site are limited or nonexistent)
- ☐ NOT APPLICABLE (the nature of the development does not lend itself to internal walking and bicycling trips)
- ☐ OTHER (Please explain)

The project proposes a multi-use path (pedestrian and bicycles facilities) throughout the development.

11. Does the site plan provide the ability to construct publicly accessible bicycling and walking connections with adjacent parcels which may be redeveloped in the future?

The ability for walkers and bicyclists to move between developments safely and conveniently reduces reliance on vehicular trips, which has congestion reduction and health benefits. Such opportunities should be considered and proactively incorporated into development site plans whenever possible.

- ☒ YES (connections to adjacent parcels are planned as part of the development)
- ☐ YES (stub outs will make future connections possible when adjacent parcels redevelop)
- ☐ NO (the development site plan does not enable walking or bicycling to/from adjacent parcels)
- ☐ NO (the site plan precludes future connections with adjacent parcels when they redevelop)
- ☐ NOT APPLICABLE (adjacent parcels are not likely to develop or redevelop in the near future)
- ☐ NOT APPLICABLE (the nature of the development or adjacent parcels does not lend itself to interparcel walking and bicycling trips)

A multi-use facility is proposed along North Druid Hills as a part of recommended transportation improvements for this project.

12. Does the site plan effectively manage truck movements and separate them, to the extent possible, from the flow of pedestrians, bicyclists and motorists both within the site and on the surrounding road network?

The ability for delivery and service vehicles to efficiently enter and exit major developments is often key to their economic success. So is the ability of visitors and customers being able to move around safely and pleasantly within the site. To the extent practical, truck movements should be segregated by minimizing the number of conflict points with publicly accessible internal roadways, sidewalks, paths and other facilities.

- ☐ YES (truck routes to serve destinations within the site are clearly delineated, provide ample space for queuing and turning around, and are separated from other users to the extent practical)
- ☐ PARTIAL (while one or more truck routes are also used by motorists and/or interface with primary walking and bicycling routes, the site plan mitigates the potential for conflict adequately)
- ☐ NO (one or more truck routes serving the site conflict directly with routes likely to be used heavily by pedestrians, bicyclists and/or motorists)
- ☒ NOT APPLICABLE (the nature of the development will not generate a wide variety of users and/or very low truck volumes, so the potential for conflict is negligible)

RECOMMENDATIONS

13. Do the transportation network recommendations outlined in the traffic study appear to be feasible from a constructability standpoint?

- ☐ UNKNOWN *(additional study is necessary)*
- ☒ YES *(based on information made available through the review process; does not represent a thorough engineering / financial analysis)*
- ☐ NO *(see comments below)*

[Click here to enter text.](#)

14. Is ARC aware of any issues with the development proposal which may result in it being opposed by one or more local governments, agencies or stakeholder groups?

- ☒ NO *(based on information shared with ARC staff prior to or during the review process; does not reflect the outcome of an extensive stakeholder engagement process)*
- ☐ YES *(see comments below)*

[Click here to enter text.](#)

15. ARC offers the following additional comments for consideration by the development team and/or the applicable local government(s):

None



Developments of Regional Impact

[DRI Home](#)
[Tier Map](#)
[Apply](#)
[View Submissions](#)
[Login](#)

DRI #2789

DEVELOPMENT OF REGIONAL IMPACT Initial DRI Information

This form is to be completed by the city or county government to provide basic project information that will allow the RDC to determine if the project appears to meet or exceed applicable DRI thresholds. Refer to both the [Rules for the DRI Process](#) and the [DRI Tiers and Thresholds](#) for more information.

Local Government Information

Submitting Local Government: Brookhaven

Individual completing form: Linda Abaray

Telephone: 404-637-0500

E-mail: Linda.abaray@brookhavenga.gov

*Note: The local government representative completing this form is responsible for the accuracy of the information contained herein. If a project is to be located in more than one jurisdiction and, in total, the project meets or exceeds a DRI threshold, the local government in which the largest portion of the project is to be located is responsible for initiating the DRI review process.

Proposed Project Information

Name of Proposed Project: Children's Healthcare of Atlanta Master Plan

Location (Street Address, GPS Coordinates, or Legal Land Lot Description): 1447 Northeast Expressway 1471 Northeast Expressway 1535 Northeast Expressway 1577 NE Expressway

Brief Description of Project: 576 hospital beds, 150 room hotel, 608,000 SF of general office, 789,233 SF of medical office, and 50,000 SF of retail

Development Type:

- | | | |
|---|---|---|
| <input type="radio"/> (not selected) | <input type="radio"/> Hotels | <input type="radio"/> Wastewater Treatment Facilities |
| <input type="radio"/> Office | <input type="radio"/> Mixed Use | <input type="radio"/> Petroleum Storage Facilities |
| <input type="radio"/> Commercial | <input type="radio"/> Airports | <input type="radio"/> Water Supply Intakes/Reservoirs |
| <input type="radio"/> Wholesale & Distribution | <input type="radio"/> Attractions & Recreational Facilities | <input type="radio"/> Intermodal Terminals |
| <input checked="" type="radio"/> Hospitals and Health Care Facilities | <input type="radio"/> Post-Secondary Schools | <input type="radio"/> Truck Stops |
| <input type="radio"/> Housing | <input type="radio"/> Waste Handling Facilities | <input type="radio"/> Any other development types |
| <input type="radio"/> Industrial | <input type="radio"/> Quarries, Asphalt & Cement Plants | |

If other development type, describe:

Project Size (# of units, floor area, etc.): 576 hospital beds, 150 room hotel, 608,000 SF of general office, 789,233 SF of medical office, and 5

Developer: Children's Healthcare of Atlanta

Mailing Address: 1665 Tullie Circle NE

Address 2:

City: Atlanta State: GA Zip: 30329

Telephone: 404-785-7162

Email: christopher.chelette@choa.org

Is property owner different from developer/applicant? ☐ (not selected) ☒ Yes ☐ No

If yes, property owner: Children's Healthcare of Atlanta and its affiliates

Is the proposed project entirely located within your local government's jurisdiction? ☐ (not selected) ☒ Yes ☐ No

If no, in what additional jurisdictions is the project located?

Is the current proposal a continuation or expansion of a previous DRI? ☐ (not selected) ☐ Yes ☒ No

If yes, provide the following information: Project Name:
Project ID:

The initial action being requested of the local government for this project: ☐ Rezoning
☐ Variance
☐ Sewer
☐ Water
☒ Permit
☐ Other

Is this project a phase or part of a larger overall project? ☐ (not selected) ☐ Yes ☒ No

If yes, what percent of the overall project does this project/phase represent?

Estimated Project Completion This project/phase: 2031
Dates: Overall project: 2031

[Back to Top](#)

[GRTA DRI Page](#) | [ARC DRI Page](#) | [RC Links](#) | [DCA DRI Page](#)

[DRI Site Map](#) | [Contact](#)



Developments of Regional Impact

[DRI Home](#)[Tier Map](#)[Apply](#)[View Submissions](#)[Login](#)

DRI #2789

DEVELOPMENT OF REGIONAL IMPACT Additional DRI Information

This form is to be completed by the city or county government to provide information needed by the RDC for its review of the proposed DRI. Refer to both the [Rules for the DRI Process](#) and the [DRI Tiers and Thresholds](#) for more information.

Local Government Information

Submitting Local Government: Brookhaven
Individual completing form: Linda Abaray
Telephone: 404-637-0500
Email: Linda.abaray@brookhavenga.gov

Project Information

Name of Proposed Project: Children's Healthcare of Atlanta Master Plan
DRI ID Number: 2789
Developer/Applicant: Children's Healthcare of Atlanta
Telephone: 404-785-7162
Email(s): christopher.chelette@choa.org

Additional Information Requested

Has the RDC identified any additional information required in order to proceed with the official regional review process? (If no, proceed to Economic Impacts.)
☐ (not selected) ☒ Yes ☐ No

If yes, has that additional information been provided to your RDC and, if applicable, GRTA?
☒ (not selected) ☐ Yes ☐ No

If no, the official review process can not start until this additional information is provided.

Economic Development

Estimated Value at Build-Out: 1.3 Billion

Estimated annual local tax revenues (i.e., property tax, sales tax) likely to be generated by the proposed development: \$100,000 in property taxes based on 2017 estimates. Annual property taxes to be determined based on development of non-exempt uses.

Is the regional work force sufficient to fill the demand created by the proposed project?
☐ (not selected) ☒ Yes ☐ No

Will this development displace any existing uses?
☐ (not selected) ☒ Yes ☐ No

If yes, please describe (including number of units, square feet, etc): The development displaces the existing CHOA administrative campus and some retail. At the time of the DRI, the active uses to be demolished consisted of 21,157 SF of church space, 485,423 SF of office space, and 20,188 SF of retail space.

Water Supply

Name of water supply provider for this site: DeKalb County

What is the estimated water supply demand to be generated by the project, measured in Millions of Gallons Per Day (MGD)? 0.364 MGD

Is sufficient water supply capacity available to serve the proposed project? ☐ (not selected) ☒ Yes ☐ No

If no, describe any plans to expand the existing water supply capacity:

Is a water line extension required to serve this project? ☐ (not selected) ☐ Yes ☒ No

If yes, how much additional line (in miles) will be required?

Wastewater Disposal

Name of wastewater treatment provider for this site: DeKalb County

What is the estimated sewage flow to be generated by the project, measured in Millions of Gallons Per Day (MGD)? 0.303 MGD

Is sufficient wastewater treatment capacity available to serve this proposed project? ☐ (not selected) ☒ Yes ☐ No

If no, describe any plans to expand existing wastewater treatment capacity:

Is a sewer line extension required to serve this project? ☐ (not selected) ☐ Yes ☒ No

If yes, how much additional line (in miles) will be required?

Land Transportation

How much traffic volume is expected to be generated by the proposed development, in peak hour vehicle trips per day? (If only an alternative measure of volume is available, please provide.) 2,686 net AM trips, 4,291 net PM trips

Has a traffic study been performed to determine whether or not transportation or access improvements will be needed to serve this project? ☐ (not selected) ☐ Yes ☒ No

Are transportation improvements needed to serve this project? ☐ (not selected) ☒ Yes ☐ No

If yes, please describe below: See DRI Traffic Study

Solid Waste Disposal

How much solid waste is the project expected to generate annually (in tons)? 5691 MGD

Is sufficient landfill capacity available to serve this proposed project? ☐ (not selected) ☒ Yes ☐ No

If no, describe any plans to expand existing landfill capacity:

Will any hazardous waste be generated by the development? ☐ (not selected) ☒ Yes ☐ No

If yes, please explain: All medical waste will be disposed in accordance with all regulations.

Stormwater Management

What percentage of the site is projected to be 27%

impervious surface once the proposed development has been constructed?

Describe any measures proposed (such as buffers, detention or retention ponds, pervious parking areas) to mitigate the project's impacts on stormwater management: Stormwater will be managed in above ground and underground detention facilities to meet the Water Quality and Stormwater Management requirements of the City, State, and Federal Government.

Environmental Quality

Is the development located within, or likely to affect any of the following:

1. Water supply watersheds? ☐ (not selected) ☐ Yes ☒ No
2. Significant groundwater recharge areas? ☐ (not selected) ☐ Yes ☒ No
3. Wetlands? ☐ (not selected) ☐ Yes ☒ No
4. Protected mountains? ☐ (not selected) ☐ Yes ☒ No
5. Protected river corridors? ☐ (not selected) ☐ Yes ☒ No
6. Floodplains? ☐ (not selected) ☒ Yes ☐ No
7. Historic resources? ☐ (not selected) ☐ Yes ☒ No
8. Other environmentally sensitive resources? ☐ (not selected) ☒ Yes ☐ No

If you answered yes to any question above, describe how the identified resource(s) may be affected:

There is a floodplain and a stream located near the eastern boundary of the Campus. The project will be developed in a manner that will minimize impact to the floodplain and the existing stream. Measures will be taken to improve the existing stream buffer areas from current conditions.

[Back to Top](#)

[GRTA DRI Page](#) | [ARC DRI Page](#) | [RC Links](#) | [DCA DRI Page](#)

[DRI Site Map](#) | [Contact](#)

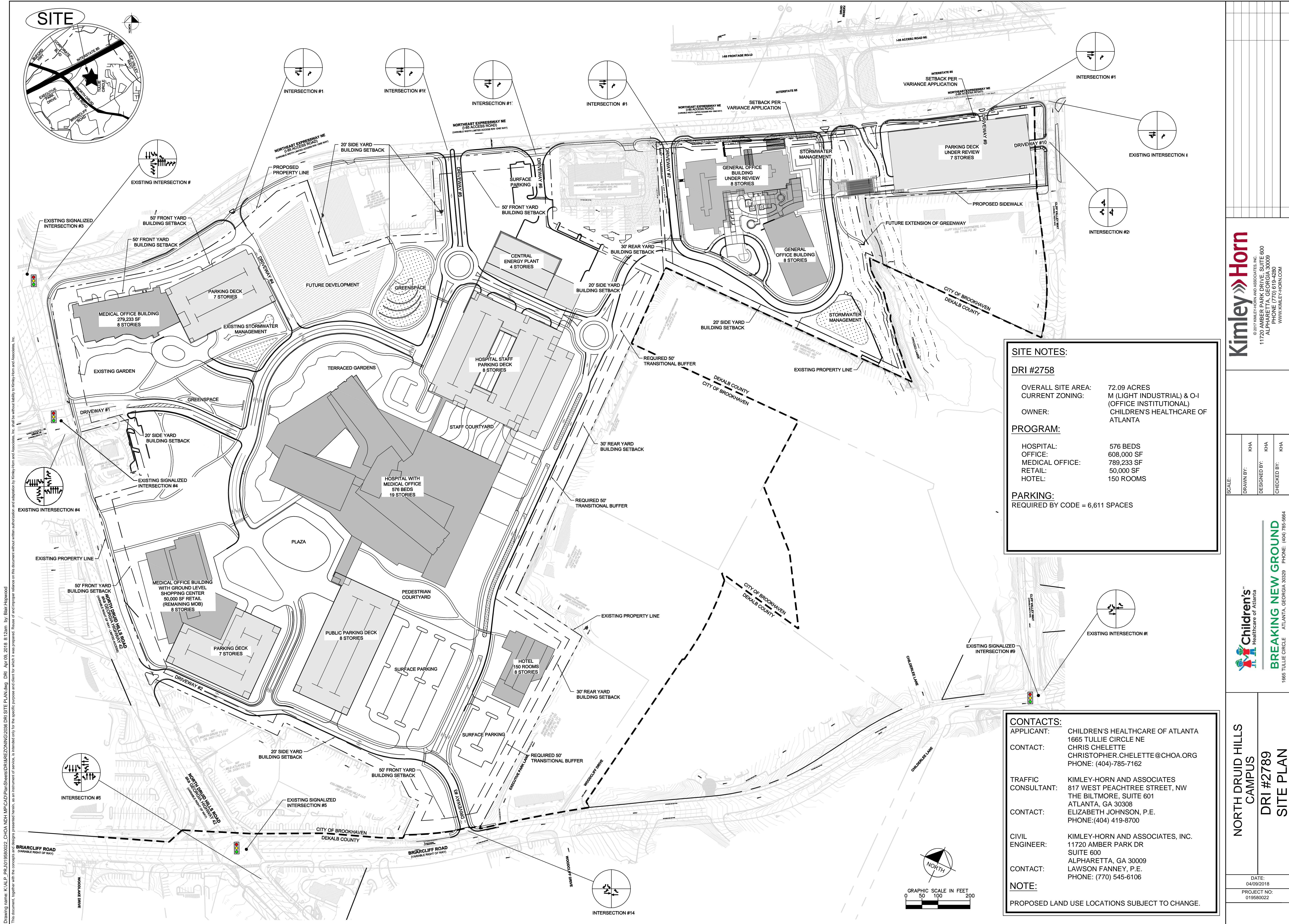

SITE NOTES:

DRI #2758

OVERALL SITE AREA: 72.09 ACRES
CURRENT ZONING: M (LIGHT INDUSTRIAL) & O-I (OFFICE INSTITUTIONAL)
OWNER: CHILDREN'S HEALTHCARE OF ATLANTA

PROGRAM:

HOSPITAL: 576 BEDS
OFFICE: 608,000 SF
MEDICAL OFFICE: 789,233 SF
RETAIL: 50,000 SF
HOTEL: 150 ROOMS

PARKING:
REQUIRED BY CODE = 6,611 SPACES

CONTACTS:

APPLICANT: CHILDREN'S HEALTHCARE OF ATLANTA
1665 TULLIE CIRCLE NE
CONTACT: CHRIS CHELETTE
CHRISTOPHER.CHELETTE@CHOA.ORG
PHONE: (404)-785-7162

TRAFFIC CONSULTANT: KIMLEY-HORN AND ASSOCIATES
817 WEST PEACHTREE STREET, NW
THE BILTMORE, SUITE 601
ATLANTA, GA 30308
ELIZABETH JOHNSON, P.E.
PHONE:(404) 419-8700

CIVIL ENGINEER: KIMLEY-HORN AND ASSOCIATES, INC.
11720 AMBER PARK DR
SUITE 600
ALPHARETTA, GA 30009
LAWSON FANNEY, P.E.
PHONE: (770) 545-6106

NOTE:
PROPOSED LAND USE LOCATIONS SUBJECT TO CHANGE.