

REGIONAL REVIEW FINDING

Atlanta Regional Commission • 229 Peachtree Street NE | Suite 100 | Atlanta, Georgia 30303 • ph: 404.463.3100 fax: 404.463.3205 • atlantaregional.org

DATE: February 6, 2018

ARC REVIEW CODE: R1801181

TO: Mayor Vince Williams, City of Union City
ATTN TO: Ellis Still, Community Development Director
FROM: Douglas R. Hooker, Executive Director, ARC
RE: Development of Regional Impact (DRI) Review



Digital signature
Original on file

The Atlanta Regional Commission (ARC) has completed a regional review of the following Development of Regional Impact (DRI). ARC reviewed the DRI with regard to its relationship to regional plans, goals and policies – and impacts it may have on the activities, plans, goals and policies of other local jurisdictions as well as state, federal and other agencies. This final report does not address whether the DRI is or is not in the best interest of the host local government.

Name of Proposal: South Fulton Parkway at Stonewall Tell (DRI 2745)

Submitting Local Government: City of Union City

Review Type: Development of Regional Impact **Date Opened:** Jan. 18, 2018 **Date Closed:** Feb. 6, 2018

Description: This DRI is on a 221.8-acre site in the City of Union City, southwest of the intersection of South Fulton Parkway and Stonewall Tell Road. The project is proposed to consist of approximately 2,095,000 SF of warehouse/distribution space in four buildings. Site access is proposed via two driveways on Stonewall Tell Road and three driveways on Koweta Road. The projected buildout year is 2020. The local trigger for this DRI review is a clearing and grubbing permit application. This site was reviewed as part of DRI 164 (Accolades at Stonewall Tell) in 2001.

Comments: According to the ARC Unified Growth Policy Map (UGPM), part of The Atlanta Region's Plan, this DRI is in the Developing Suburbs Area of the region. Developing Suburbs are areas that have developed from roughly 1995 to today and are projected to remain suburbs through 2040. ARC's Regional Development Guide (RDG) details recommended policies for areas on the UGPM. RDG information and recommendations for Developing Suburbs are listed at the bottom of these comments.

This DRI appears to manifest some aspects of regional policy in that it is in relatively close proximity to existing warehouse/distribution facilities along South Fulton Parkway to the east, offering the potential for efficiencies in freight movement. It also offers connectivity for regional freight movement through its access to SR 92 to the west, Roosevelt Highway/US 29 to the south, and I-285 and I-85 to the east.

The project could further support The Atlanta Region's Plan if it incorporated other aspects of the regional policy detailed at the bottom of these comments, including green infrastructure and/or low-impact design (e.g., rain gardens, vegetated swales, etc.) in parking areas and site driveways, and as part of any improvements to site frontages. In addition, ARC encourages the applicant team to ensure that the development promotes a functional, safe, clearly marked and comfortable pedestrian experience on all streets, paths and parking areas on the site. This framework can offer the potential for safe internal site circulation for employees on foot or by another alternative mode.

The intensity of this DRI generally aligns with the RDG's recommended range of densities and building heights in Developing Suburbs. In terms of land use, the project is similar to nearby warehouse/distribution space and is in an area of the region that is experiencing demand for the development of these types of facilities. However, many areas around this site are predominated by forested/conservation land or low-density residential uses, including many areas and properties that are outside the City of Union City, e.g.,

City of South Fulton, among others. Union City leadership and staff, along with the applicant team, should therefore collaborate to ensure sensitivity to nearby local governments, land uses and natural resources to the greatest extent possible.

ARC staff comments related to water resources and transportation, along with external comments received during the review, are attached to this report.

Further to the above, regional policy recommendations for Developing Suburbs include:

- New development should connect to the existing road network and adjacent developments and use of cul-de-sacs or other means resulting in disconnected subdivisions should be discouraged
- Maximize the usefulness of existing recreational facilities in addition to providing new recreational opportunities
- Eliminate vacant or under-utilized parking areas through mechanisms such as out-parceling or conversion to community open space
- Use rain gardens, vegetated swales or other enhanced water filtration design to enhance the quality of stormwater run-off
- Identify other opportunities to foster a sense of community by developing town centers, village centers or other places of centralized location

THE FOLLOWING LOCAL GOVERNMENTS AND AGENCIES RECEIVED NOTICE OF THIS REVIEW:

ARC COMMUNITY DEVELOPMENT
ARC RESEARCH & ANALYTICS
GEORGIA DEPARTMENT OF TRANSPORTATION
AEROTROPOLIS ATLANTA CIDS
CITY OF EAST POINT

ARC TRANSPORTATION ACCESS & MOBILITY
GEORGIA DEPARTMENT OF COMMUNITY AFFAIRS
GEORGIA REGIONAL TRANSPORTATION AUTHORITY
CITY OF CHATTAHOOCHEE HILLS
CITY OF FAIRBURN

ARC NATURAL RESOURCES
GEORGIA DEPARTMENT OF NATURAL RESOURCES
METROPOLITAN ATLANTA RAPID TRANSIT AUTHORITY
CITY OF COLLEGE PARK
CITY OF SOUTH FULTON

If you have any questions regarding this review, please contact Andrew Smith at (470) 378-1645 or asmith@atlantaregional.org. This finding will be published to the ARC review website located at <http://atlantaregional.org/plan-reviews>.

Andrew Smith

From: Weiss, Megan J <MWeiss@dot.ga.gov>
Sent: Thursday, January 25, 2018 8:57 AM
To: Andrew Smith
Cc: Robinson, Charles A.; Peevy, Phillip M.
Subject: FW: ARC DRI Review Notification: South Fulton Parkway at Stonewall Tell (DRI 2745)

Andrew.

The GDOT Office of Planning has reviewed the South Fulton Parkway at Stonewall Tell DRI Preliminary report and show one GDOT projects in the vicinity:

GDOT Project Identification No. (PI No.) 0007533 – Butner Road Intersection Improvements/Congestion Reduction and Traffic Flow Improvements -The GDOT Project Manager for this project is Ruthie Jones and can be reached at 678-802-1103 or RuJones@dot.ga.gov.

For further information that may be needed concerning this review, please contact me at 404-631-1779 or mweiss@dot.ga.gov.

Megan Weiss, AICP
Transportation Planner III
Georgia Department of Transportation
Office of Planning-5th Floor
P:404-631-1779 E:mweiss@dot.ga.gov

From: Andrew Smith [<mailto:ASmith@atlantaregional.org>]
Sent: Thursday, January 18, 2018 4:50 PM
To: VanDyke, Cindy <cyvandyke@dot.ga.gov>; Fowler, Matthew <mfowler@dot.ga.gov>; Matthews, Timothy W <TMatthews@dot.ga.gov>; Garth Lynch <glynch@HNTB.com>; Wayne Mote <wmote@HNTB.com>; Peevy, Phillip M. <PPeevy@dot.ga.gov>; Robinson, Charles A. <chrobinson@dot.ga.gov>; Weiss, Megan J <MWeiss@dot.ga.gov>; Lawrence, Roshni R <RoLawrence@dot.ga.gov>; Comer, Carol <ccomer@dot.ga.gov>; Hood, Alan C. <achood@dot.ga.gov>; Zahul, Kathy <kzahul@dot.ga.gov>; DeNard, Paul <pdenard@dot.ga.gov>; Regis, Edlin <eregis@dot.ga.gov>; Woods, Chris N. <cwoods@dot.ga.gov>; Johnson, Lankston <lajohnson@dot.ga.gov>; Boone, Eric <eboone@dot.ga.gov>; Annie Gillespie <agillespie@srta.ga.gov>; Emily Estes <eestes@srta.ga.gov>; Parker Martin <PMartin@srta.ga.gov>; 'DRI@grta.org' <DRI@grta.org>; 'Jon West' <jon.west@dca.ga.gov>; jud.turner@gaepd.org; chuck.mueller@dnr.state.ga.us; Greg Floyd <gfloyd@itsmarta.com> <gfloyd@itsmarta.com>; Kirsten Mote <kmote@aerocids.com>; sreecy@aerocids.com; michael.morton@chatthillsga.us; aclement@tcfatl.com; Nigel Roberts <nroberts@eastpointcity.org>; Angela Blatch <ablatch@EastPointCity.org>; flee@eastpointcity.org; tpeeks@fairburn.com; Brendetta Walker <bwalker@fairburn.com>; philip.etiwe@cityofsouthfultonga.gov; Shayla Reed <Shayla.Reed@cityofsouthfultonga.gov>; briannarindge@cityofsouthfultonga.gov; Ellis Still <estill@unioncityga.org>; Maurice Ungaro <mungaro@unioncityga.org>; Maureen McDonnell <mmcdonnell@maai.net>; Chris Kingsbury <ckingsbury@maai.net>; Brown, Scott <SBrown@majesticrealty.com>; Woody Galloway <woody@glawgp.com>; John Wise <jwise@paulsonmitchell.com>; Walker, John <John.Walker@kimley-horn.com>; Johnson, Elizabeth <elizabeth.johnson@kimley-horn.com>; Seo, Jinwoo <jinwoo.seo@kimley-horn.com>; matt.flynn@kimley-horn.com
Cc: Community Development <CommunityDevelopment@atlantaregional.org>; Mike Alexander <MAlexander@atlantaregional.org>; David Haynes <DHaynes@atlantaregional.org>; Marquitrice Mangham <MMangham@atlantaregional.org>; Audrey Johnson <AuJohnson@atlantaregional.org>; Ryan Ellis <REllis@atlantaregional.org>; Jim Santo <JSanto@atlantaregional.org>; Jim Skinner <JSkinner@atlantaregional.org>
Subject: ARC DRI Review Notification: South Fulton Parkway at Stonewall Tell (DRI 2745)

Development of Regional Impact (DRI) – Request for Comments

This e-mail serves as notice that the Atlanta Regional Commission (ARC) has begun a Development of Regional Impact (DRI) review for **South Fulton Parkway at Stonewall Tell (DRI 2745)**.

This DRI is on a 221.8-acre site in the City of Union City, southwest of the intersection of South Fulton Parkway and Stonewall Tell Road. The project is proposed to consist of approximately 2,095,000 SF of warehouse/distribution space in four buildings. Site access is proposed via two driveways on Stonewall Tell Road and three driveways on Koweta Road. The projected buildout year is 2020. The local trigger for this DRI review is a clearing and grubbing permit application. This site was reviewed as part of DRI 164 (Accolades at Stonewall Tell) in 2001.

As a representative of a nearby local government or other potentially affected party, we request that you or your staff review the attached ARC Preliminary Report and provide any comments to ARC on or before **Friday, February 2, 2018**.

You may also view the Preliminary Report and other project information by visiting the [ARC Plan Reviews webpage](#) beginning tomorrow, January 19, and entering "South Fulton Parkway at Stonewall Tell" in the search field at the bottom of the page.

Comments may be directed to me via email reply (asmith@atlantaregional.org) or via U.S. mail to the mailing address noted below.

For more information regarding the DRI process, please visit the [ARC DRI webpage](#).

Regards,

Andrew Smith

Principal Planner, Community Development

Atlanta Regional Commission

P | 470.378.1645

asmith@atlantaregional.org

atlantaregional.org

International Tower

229 Peachtree Street NE | Suite 100

Atlanta, Georgia 30303

Roadway fatalities in Georgia are up 33% in two years. That's an average of four deaths every single day! Many of these deaths are preventable and related to driver behavior: distracted or impaired driving, driving too fast for conditions, and/or failure to wear a seatbelt. Pledge to **DRIVE ALERT ARRIVE ALIVE**. Buckle up – Stay off the phone and mobile devices – Drive alert. Visit www.dot.ga.gov/DAAA. #ArriveAliveGA

Andrew Smith

From: Hood, Alan C. <achood@dot.ga.gov>
Sent: Tuesday, January 30, 2018 9:47 AM
To: Andrew Smith
Cc: Brian, Steve; Comer, Carol; Edmisten, Colette
Subject: RE: ARC DRI Review Notification: South Fulton Parkway at Stonewall Tell (DRI 2745)
Attachments: ARC Preliminary Report - South Fulton Parkway at Stonewall Tell DRI 2745.pdf

Andrew,

The proposed development consisting of approximately 2,095,000 SF of warehouse/distribution space in four buildings, is located less than 7 miles west of Hartsfield-Jackson Atlanta International Airport (ATL), but is not an obstruction to any FAA Part 77 surface, and does not appear to impact the airport.

However, the proposed construction is in proximity to a navigation facility and may impact the assurance of navigation signal reception. The FAA, in accordance with CFR Title 14 Part 77.9, requests that you file. An FAA Form 7460-1 must be submitted to the Federal Aviation Administration. That may be done online at <https://oeaaa.faa.gov>. The FAA must be in receipt of the notification, no later than 120 days prior to construction. The FAA will evaluate the potential impact of the project on protected airspace associated with any airport and advise the proponent if any action is necessary.

Thank you for the opportunity to comment on the proposed development.

Alan Hood | Airport Safety Data Program Manager
Georgia Department of Transportation - Aviation Programs
600 West Peachtree Street, N.W. | 2nd Floor | Atlanta, Georgia 30308
M: 404-660-3394 | F: 404-631-1935 | E: achood@dot.ga.gov

View our website at <http://www.dot.ga.gov/IS/AirportAid>

From: Andrew Smith [mailto:ASmith@atlantaregional.org]
Sent: Thursday, January 18, 2018 4:50 PM
To: VanDyke, Cindy <cyvandyke@dot.ga.gov>; Fowler, Matthew <mfowler@dot.ga.gov>; Matthews, Timothy W <TMatthews@dot.ga.gov>; Garth Lynch <glynch@HNTB.com>; Wayne Mote (wmote@HNTB.com) <wmote@HNTB.com>; Peevy, Phillip M. <PPeevy@dot.ga.gov>; Robinson, Charles A. <chrobinson@dot.ga.gov>; Weiss, Megan J <MWeiss@dot.ga.gov>; Lawrence, Roshni R <RoLawrence@dot.ga.gov>; Comer, Carol <ccomer@dot.ga.gov>; Hood, Alan C. <achood@dot.ga.gov>; Zahul, Kathy <kzahul@dot.ga.gov>; DeNard, Paul <pdenard@dot.ga.gov>; Regis, Edlin <eregis@dot.ga.gov>; Woods, Chris N. <cwoods@dot.ga.gov>; Johnson, Lankston <lajohnson@dot.ga.gov>; Boone, Eric <eboone@dot.ga.gov>; Annie Gillespie <agillespie@srta.ga.gov>; Emily Estes <eestes@srta.ga.gov>; Parker Martin <PMartin@srta.ga.gov>; 'DRI@grta.org' <DRI@grta.org>; 'Jon West' <jon.west@dca.ga.gov>; jud.turner@gaepd.org; chuck.mueller@dnr.state.ga.us; Greg Floyd (gfloyd@itsmarta.com) <gfloyd@itsmarta.com>; Kirsten Mote <kmote@aerocids.com>; sreecy@aerocids.com; michael.morton@chatthillsga.us; aclement@tcfatl.com; Nigel Roberts <nroberts@eastpointcity.org>; Angela Blatch <ablatch@EastPointCity.org>; flee@eastpointcity.org; tpeeks@fairburn.com; Brendetta Walker <bwalker@fairburn.com>; philip.etiwe@cityofsouthfultonga.gov; Shayla Reed <Shayla.Reed@cityofsouthfultonga.gov>; briannarindge@cityofsouthfultonga.gov; Ellis Still <estill@unioncityga.org>; Maurice Ungaro <mungaro@unioncityga.org>; Maureen McDonnell <mmcdonnell@maai.net>; Chris Kingsbury <ckingsbury@maai.net>; Brown, Scott <SBrown@majesticrealty.com>; Woody Galloway <woody@glawgp.com>; John Wise <jwise@paulsonmitchell.com>; Walker, John <John.Walker@kimley-horn.com>; Johnson, Elizabeth <elizabeth.johnson@kimley-horn.com>; Seo, Jinwoo <jinwoo.seo@kimley-horn.com>; matt.flynn@kimley-horn.com
Cc: Community Development <CommunityDevelopment@atlantaregional.org>; Mike Alexander

<MAlexander@atlantaregional.org>; David Haynes <DHaynes@atlantaregional.org>; Marquitrice Mangham <MMangham@atlantaregional.org>; Audrey Johnson <AuJohnson@atlantaregional.org>; Ryan Ellis <REllis@atlantaregional.org>; Jim Santo <JSanto@atlantaregional.org>; Jim Skinner <JSkinner@atlantaregional.org>
Subject: ARC DRI Review Notification: South Fulton Parkway at Stonewall Tell (DRI 2745)

Development of Regional Impact (DRI) – Request for Comments

This e-mail serves as notice that the Atlanta Regional Commission (ARC) has begun a Development of Regional Impact (DRI) review for **South Fulton Parkway at Stonewall Tell (DRI 2745)**.

This DRI is on a 221.8-acre site in the City of Union City, southwest of the intersection of South Fulton Parkway and Stonewall Tell Road. The project is proposed to consist of approximately 2,095,000 SF of warehouse/distribution space in four buildings. Site access is proposed via two driveways on Stonewall Tell Road and three driveways on Koweta Road. The projected buildout year is 2020. The local trigger for this DRI review is a clearing and grubbing permit application. This site was reviewed as part of DRI 164 (Accolades at Stonewall Tell) in 2001.

As a representative of a nearby local government or other potentially affected party, we request that you or your staff review the attached ARC Preliminary Report and provide any comments to ARC on or before **Friday, February 2, 2018**.

You may also view the Preliminary Report and other project information by visiting the [ARC Plan Reviews webpage](#) beginning tomorrow, January 19, and entering “South Fulton Parkway at Stonewall Tell” in the search field at the bottom of the page.

Comments may be directed to me via email reply (asmith@atlantaregional.org) or via U.S. mail to the mailing address noted below.

For more information regarding the DRI process, please visit the [ARC DRI webpage](#).

Regards,

Andrew Smith

Principal Planner, Community Development

Atlanta Regional Commission

P | 470.378.1645

asmith@atlantaregional.org

atlantaregional.org

International Tower

229 Peachtree Street NE | Suite 100

Atlanta, Georgia 30303

Roadway fatalities in Georgia are up 33% in two years. That's an average of four deaths every single day! Many of these deaths are preventable and related to driver behavior: distracted or impaired driving, driving too fast for conditions, and/or failure to wear a seatbelt. Pledge to **DRIVE ALERT ARRIVE ALIVE**. Buckle up – Stay off the phone and mobile devices – Drive alert. Visit www.dot.ga.gov/DAAA. #ArriveAliveGA

SOUTH FULTON PARKWAY AT STONEWALL TELL DRI
City of Union City
Natural Resources Group Review Comments

January 11, 2018

Watershed and Stream Protection

The project site is in the Deep Creek watershed, which is within the Chattahoochee River Watershed, but it is not within the 2000-foot Chattahoochee River Corridor of the Metropolitan River Protection Act. Deep Creek enters the Chattahoochee downstream of the portion of the river that serves as a water supply source in the Atlanta Region.

The USGS coverage for the project area shows a blue -line stream flowing west and northwest from the existing pond in the center of the property. A second blue-line stream flowing from the north joins the first stream in the northwestern corner of the property near South Wexford Road. While the existing pond is shown on the project site plan, neither stream is shown and no buffers are indicated. These streams, as well as any other streams on the property, may be subject to the requirements of the Union City Stream Buffer Protection Ordinance, which requires a 50-foot stream buffer and 75-foot impervious setback on all streams that meet the ordinance's definition of a stream. Final determination of the buffer requirement is the City's. In addition, no 25-foot State sedimentation and erosion control buffer is visible along the streams on the submitted plan. It also needs to be shown for applicable streams and other waters of the state on this property.

Stormwater / Water Quality

The project should adequately address the impacts of the proposed development on stormwater runoff and downstream water quality. During construction, the project should conform to the relevant state and federal erosion and sedimentation control requirements. After construction, as with all development, water quality will be impacted due to polluted stormwater runoff. The amount of pollutants that will be produced after construction of the proposed development are dependent on the type and intensity of the use and the impervious coverage, which will affect the design of stormwater controls for the project.

In order to address post-construction stormwater runoff quality, the project should implement stormwater management controls (structural and/or nonstructural) as found in the Georgia Stormwater Management Manual (www.georgiastormwater.com) and meet the stormwater management quantity and quality criteria outlined in the Manual. Where possible, the project should utilize the stormwater better site design concepts included in the Manual.

Development of Regional Impact Assessment of Consistency with the Regional Transportation Plan

DRI INFORMATION

DRI Number #2745
DRI Title South Fulton Parkway at Stonewall Tell
County Fulton County
City (if applicable) Union City
Address / Location The site is located on the southwest of the intersection of South Fulton Parkway (SR 14) to the north and Stonewall Tell Road to the east and Koweta Road to the south

Proposed Development Type:

Industrial development on +/-221 acres consisting of four buildings with 2,095,000
Sf of High Cube warehouse

Review Process ☐ EXPEDITED
☒ NON-EXPEDITED

REVIEW INFORMATION

Prepared by ARC Transportation Access and Mobility Division
Staff Lead Marquitrice Mangham
Copied [Click here to enter text.](#)
Date January 16, 2018

TRAFFIC STUDY

Prepared by Kimley Horn
Date January 8, 2018

REGIONAL TRANSPORTATION PLAN PROJECTS

- 01. Did the traffic analysis incorporate all projects contained in the current version of the fiscally constrained RTP which are within the study area or along major transportation corridors connecting the study area with adjacent jurisdictions?**

☒ YES *(provide the regional plan referenced and the page number of the traffic study where relevant projects are identified)*

The traffic analysis references page 30 for programmed projects. A project fact sheet was included in the analysis for project FS 208 at Stonewall Tell and Butner Road. Additional projects not identified are: FS 289 Buffington Road Widening from Rock Quarry to SR 14 and FS 283 US 29 Bridge Upgrade

☐ NO *(provide comments below)*

REGIONAL NETWORKS

- 02. Will the development site be directly served by any roadways identified as Regional Thoroughfares?**

A Regional Thoroughfare is a major transportation corridor that serves multiple ways of traveling, including walking, bicycling, driving, and riding transit. It connects people and goods to important places in metropolitan Atlanta. A Regional Thoroughfare's operations should be managed through application of special traffic control strategies and suitable land development guidelines in order to maintain travel efficiency, reliability, and safety for all users. In light of the special function that Regional Thoroughfares serve in supporting cross-regional and interjurisdictional mobility and access, the network receives priority consideration for infrastructure investment in the Metro Atlanta region. Any access points between the development and a Regional Thoroughfare, combined with the development's on-site circulation patterns, must be designed with the goal of preserving the highest possible level of capacity and safety for all users of the roadway.

☒ NO

☐ YES *(identify the roadways and existing/proposed access points)*

The site access is proposed by five points: Two on Stonewall Tell Road and three on Koweta Road. Neither are Regional Thoroughfares.

03. Will the development site be directly served by any roadways identified as Regional Truck Routes?

A Regional Truck Route is a freeway, state route or other roadway which serves as a critical link for the movement of goods to, from and within the Region by connecting airports, intermodal/multimodal facilities, distribution and warehousing centers and manufacturing clusters with the rest of the state and nation. These facilities often serve a key mobility and access function for other users as well, including drivers, bicyclists, pedestrians and transit users. A Regional Truck Route's operations should be managed through application of special traffic control strategies and suitable land development guidelines in order to maintain travel efficiency, reliability, and safety for all users. In light of the special function that Regional Truck Routes serve in supporting cross-regional and interjurisdictional mobility and access, the network receives priority consideration for infrastructure investment in the Metro Atlanta region. Any access points between the development and a Regional Truck Route, combined with the development's on-site circulation patterns, must be designed with the goal of preserving the highest possible level of capacity and safety for all users of the roadway.

☒ NO

☐ YES (*identify the roadways and existing/proposed access points*)

The site access is proposed by five full movement points: Two on Stonewall Tell Road and three on Koweta Road. Neither are Regional Truck routes

04. If the development site is within one mile of an existing rail service, provide information on accessibility conditions.

Access between major developments and transit services provide options for people who cannot or prefer not to drive, expand economic opportunities by better connecting people and jobs, and can help reduce congestion. If a transit service is available nearby, but walking or bicycling between the development site and the nearest station is a challenge, the applicable local government(s) is encouraged to make the route a funding priority for future walking and bicycling infrastructure improvements.

☒ NOT APPLICABLE (*nearest station more than one mile away*)

☐ RAIL SERVICE WITHIN ONE MILE (*provide additional information below*)

Operator / Rail Line

Nearest Station

[Click here to enter name of operator and rail line](#)

Distance*

☐ Within or adjacent to the development site (0.10 mile or less)

☐ 0.10 to 0.50 mile

☐ 0.50 to 1.00 mile

Walking Access*

☐ Sidewalks and crosswalks provide sufficient connectivity

☐ Sidewalk and crosswalk network is incomplete

☐ Not applicable (*accessing the site by walking is not consistent with the type of development proposed*)

[Click here to provide comments.](#)

Bicycling Access*

☐ Dedicated paths, lanes or cycle tracks provide sufficient connectivity

☐ Low volume and/or low speed streets provide connectivity

☐ Route follows high volume and/or high speed streets

☐ Not applicable (*accessing the site by bicycling is not consistent with the type of development proposed*)

Transit Connectivity

☐ Fixed route transit agency bus service available to rail station

☐ Private shuttle or circulator available to rail station

☐ No services available to rail station

☐ Not applicable (*accessing the site by transit is not consistent with the type of development proposed*)

[Click here to provide comments.](#)

** Following the most direct feasible walking or bicycling route to the nearest point on the development site*

05. If there is currently no rail transit service within one mile of the development site, is nearby rail service planned in the fiscally constrained RTP?

Access between major developments and transit services provide options for people who cannot or prefer not to drive, expand economic opportunities by better connecting people and jobs, and can help reduce traffic congestion. If a transit agency operates within the jurisdiction and expansion plans are being considered in the general vicinity of the development site, the agency should give consideration to how the site can be best served during the evaluation of alignments and station locations. Proactive negotiations with the development team and local government(s) are encouraged to determine whether right-of-way within the site should be identified and protected for potential future service. If direct service to the site is not feasible or cost effective, the transit agency and local government(s) are encouraged to ensure good walking and bicycling access accessibility is provided between the development and the future rail line. These improvements should be considered fundamental components of the overall transit expansion project, with improvements completed concurrent with or prior to the transit service being brought online.

- ☐ NOT APPLICABLE (rail service already exists)
- ☐ NOT APPLICABLE (accessing the site by transit is not consistent with the type of development proposed)
- ☒ NO (no plans exist to provide rail service in the general vicinity)
- ☐ YES (provide additional information on the timeframe of the expansion project below)
 - ☐ CST planned within TIP period
 - ☐ CST planned within first portion of long range period
 - ☐ CST planned near end of plan horizon

[Click here to provide comments.](#)

06. If the development site is within one mile of fixed route bus services (including any privately operated shuttles or circulators open to the general public), provide information on walking and bicycling accessibility conditions.

Access between major developments and transit services provide options for people who cannot or prefer not to drive, expand economic opportunities by better connecting people and jobs, and can help reduce congestion. If a transit service is available nearby, but walking or bicycling between the development site and the nearest station is a challenge, the applicable local government(s) is encouraged to make the connection a funding priority for future walking and bicycling infrastructure improvements.

☒ NOT APPLICABLE (nearest bus, shuttle or circulator stop more than one mile away)

☐ SERVICE WITHIN ONE MILE (provide additional information below)

Operator(s) [Click here to enter name of operator\(s\).](#)

Bus Route(s) [Click here to enter bus route number\(s\).](#)

Distance* ☐ Within or adjacent to the development site (0.10 mile or less)

☐ 0.10 to 0.50 mile

☐ 0.50 to 1.00 mile

Walking Access* ☐ Sidewalks and crosswalks provide sufficient connectivity

☐ Sidewalk and crosswalk network is incomplete

☐ Not applicable (accessing the site by walking is not consistent with the type of development proposed)

[Click here to provide comments.](#)

Bicycling Access* ☐ Dedicated paths, lanes or cycle tracks provide sufficient connectivity

☐ Low volume and/or low speed streets provide sufficient connectivity

☐ Route uses high volume and/or high speed streets

☐ Not applicable (accessing the site by bicycling is not consistent with the type of development proposed)

* Following the most direct feasible walking or bicycling route to the nearest point on the development site

07. Does a transit agency which provides rail and/or fixed route bus service operate anywhere within the jurisdiction in which the development site is located?

Access between major developments and transit services provide options for people who cannot or prefer not to drive, expand economic opportunities by better connecting people and jobs, and can help reduce traffic congestion. If a transit agency operates within the jurisdiction and a comprehensive operations plan update is undertaken, the agency should give consideration to serving the site during the evaluation of future routes, bus stops and transfer facilities. If the nature of the development is amenable to access by transit, walking or bicycling, but direct service to the site is not feasible or cost effective, the transit agency and local government(s) should ensure good walking and bicycling access accessibility is provided between the development and any routes within a one mile radius. The applicable local government(s) is encouraged to make these connections a funding priority for future walking and bicycling infrastructure improvements.

☐ NO

☒ YES

08. If the development site is within one mile of an existing multi-use path or trail, provide information on accessibility conditions.

Access between major developments and walking/bicycling facilities provide options for people who cannot or prefer not to drive, expand economic opportunities by better connecting people and jobs, and can help reduce traffic congestion. If connectivity with a regionally significant path or trail is available nearby, but walking or bicycling between the development site and those facilities is a challenge, the applicable local government(s) is encouraged to make the route a funding priority for future walking and bicycling infrastructure improvements.

☒ NOT APPLICABLE (nearest path or trail more than one mile away)

☐ YES (provide additional information below)

Name of facility

[Click here to provide name of facility.](#)

Distance

☐ Within or adjacent to development site (0.10 mile or less)

☐ 0.15 to 0.50 mile

☐ 0.50 to 1.00 mile

Walking Access*

☐ Sidewalks and crosswalks provide connectivity

☐ Sidewalk and crosswalk network is incomplete

☐ Not applicable (accessing the site by walking is not consistent with the type of development proposed)

Bicycling Access*

☐ Dedicated lanes or cycle tracks provide connectivity

☐ Low volume and/or low speed streets provide connectivity

☐ Route uses high volume and/or high speed streets

☐ Not applicable (*accessing the site by bicycling is not consistent with the type of development proposed*)

* *Following the most direct feasible walking or bicycling route to the nearest point on the development site*

OTHER TRANSPORTATION DESIGN CONSIDERATIONS

09. Does the site plan provide for the construction of publicly accessible local road or drive aisle connections with adjacent parcels?

The ability for drivers and bus routes to move between developments without using the adjacent arterial or collector roadway networks can save time and reduce congestion. Such opportunities should be considered and proactively incorporated into development site plans whenever possible.

- ☐ YES (*connections to adjacent parcels are planned as part of the development*)
- ☐ YES (*stub outs will make future connections possible when adjacent parcels redevelop*)
- ☐ NO (*the site plan precludes future connections with adjacent parcels when they redevelop*)
- ☒ OTHER (*Please explain*)

Connections to adjacent parcels can be made by local roads however adjacent uses are not compatible with proposed development use.

10. Does the site plan enable pedestrians and bicyclists to move between destinations within the development site safely and conveniently?

The ability for walkers and bicyclists to move within the site safely and conveniently reduces reliance on vehicular trips, which has congestion reduction and health benefits. Development site plans should incorporate well designed and direct sidewalk connections between all key destinations. To the extent practical, bicycle lanes or multiuse paths are encouraged for large acreage sites and where high volumes of bicyclists and pedestrians are possible.

- ☐ YES (sidewalks provided on all key walking routes and both sides of roads whenever practical and bicyclists should have no major issues navigating the street network)
- ☐ PARTIAL (some walking and bicycling facilities are provided, but connections are not comprehensive and/or direct)
- ☐ NO (walking and bicycling facilities within the site are limited or nonexistent)
- ☐ NOT APPLICABLE (the nature of the development does not lend itself to internal walking and bicycling trips)
- ☒ OTHER (Please explain)

The site plan proposes 1291 parking spaces. The development does not propose bicycle and pedestrian facilities. Pedestrians, cyclist, vehicles and freight trucks will utilize the same driveways to move throughout the development.

11. Does the site plan provide the ability to construct publicly accessible bicycling and walking connections with adjacent parcels which may be redeveloped in the future?

The ability for walkers and bicyclists to move between developments safely and conveniently reduces reliance on vehicular trips, which has congestion reduction and health benefits. Such opportunities should be considered and proactively incorporated into development site plans whenever possible.

- ☐ YES (connections to adjacent parcels are planned as part of the development)
- ☐ YES (stub outs will make future connections possible when adjacent parcels redevelop)
- ☒ NO (the development site plan does not enable walking or bicycling to/from adjacent parcels)
- ☐ NO (the site plan precludes future connections with adjacent parcels when they redevelop)
- ☐ NOT APPLICABLE (adjacent parcels are not likely to develop or redevelop in the near future)
- ☐ NOT APPLICABLE (the nature of the development or adjacent parcels does not lend itself to interparcel walking and bicycling trips)

The site plan does not provide specific information or depictions of bicycle and pedestrian facilities.

12. Does the site plan effectively manage truck movements and separate them, to the extent possible, from the flow of pedestrians, bicyclists and motorists both within the site and on the surrounding road network?

The ability for delivery and service vehicles to efficiently enter and exit major developments is often key to their economic success. So is the ability of visitors and customers being able to move around safely and pleasantly within the site. To the extent practical, truck movements should be segregated by minimizing the number of conflict points with publicly accessible internal roadways, sidewalks, paths and other facilities.

- ☐ YES (truck routes to serve destinations within the site are clearly delineated, provide ample space for queuing and turning around, and are separated from other users to the extent practical)
- ☐ PARTIAL (while one or more truck routes are also used by motorists and/or interface with primary walking and bicycling routes, the site plan mitigates the potential for conflict adequately)
- ☒ NO (one or more truck routes serving the site conflict directly with routes likely to be used heavily by pedestrians, bicyclists and/or motorists)
- ☐ NOT APPLICABLE (the nature of the development will not generate a wide variety of users and/or very low truck volumes, so the potential for conflict is negligible)

All five site access points allow for the both vehicle and freight access.

RECOMMENDATIONS

13. Do the transportation network recommendations outlined in the traffic study appear to be feasible from a constructability standpoint?

- ☐ UNKNOWN (additional study is necessary)
- ☒ YES (based on information made available through the review process; does not represent a thorough engineering / financial analysis)
- ☐ NO (see comments below)

Click here to enter text.

14. Is ARC aware of any issues with the development proposal which may result in it being opposed by one or more local governments, agencies or stakeholder groups?

- ☒ NO (based on information shared with ARC staff prior to or during the review process; does not reflect the outcome of an extensive stakeholder engagement process)
- ☐ YES (see comments below)

Click here to enter text.

15. ARC offers the following additional comments for consideration by the development team and/or the applicable local government(s):

None



Developments of Regional Impact

[DRI Home](#)
[Tier Map](#)
[Apply](#)
[View Submissions](#)
[Login](#)

DRI #2745

DEVELOPMENT OF REGIONAL IMPACT Initial DRI Information

This form is to be completed by the city or county government to provide basic project information that will allow the RDC to determine if the project appears to meet or exceed applicable DRI thresholds. Refer to both the [Rules for the DRI Process](#) and the [DRI Tiers and Thresholds](#) for more information.

Local Government Information

Submitting Local Government: Union City

Individual completing form: Ellis Still

Telephone: 770-515-7955

E-mail: estill@unioncityga.org

*Note: The local government representative completing this form is responsible for the accuracy of the information contained herein. If a project is to be located in more than one jurisdiction and, in total, the project meets or exceeds a DRI threshold, the local government in which the largest portion of the project is to be located is responsible for initiating the DRI review process.

Proposed Project Information

Name of Proposed Project: S. Fulton Pkwy @ Stonewall Tell

Location (Street Address, GPS Coordinates, or Legal Land Lot Description): Southwest quadrant of S. Fulton Pkwy/Stonewall Tell Road

Brief Description of Project: A 221.8 acre tract to be developed into a total of 5 building totaling 2,095,000 square feet for Industrial uses.

Development Type:

- | | | |
|--|---|---|
| <input type="radio"/> (not selected) | <input type="radio"/> Hotels | <input type="radio"/> Wastewater Treatment Facilities |
| <input type="radio"/> Office | <input type="radio"/> Mixed Use | <input type="radio"/> Petroleum Storage Facilities |
| <input type="radio"/> Commercial | <input type="radio"/> Airports | <input type="radio"/> Water Supply Intakes/Reservoirs |
| <input type="radio"/> Wholesale & Distribution | <input type="radio"/> Attractions & Recreational Facilities | <input type="radio"/> Intermodal Terminals |
| <input type="radio"/> Hospitals and Health Care Facilities | <input type="radio"/> Post-Secondary Schools | <input type="radio"/> Truck Stops |
| <input type="radio"/> Housing | <input type="radio"/> Waste Handling Facilities | <input type="radio"/> Any other development types |
| <input checked="" type="radio"/> Industrial | <input type="radio"/> Quarries, Asphalt & Cement Plants | |

If other development type, describe:

Project Size (# of units, floor area, etc.): 2,095,000 square feet

Developer: Majestic Realty Co.

Mailing Address: 3490 Piedmont Road NE

Address 2: Suite 210

City: Atlanta State: GA Zip: 30305

Telephone: 404-467-5261

Email: sbrown@majesticrealty.com

Is property owner different from developer/applicant? ☐ (not selected) ☐ Yes ☒ No

If yes, property owner:

Is the proposed project entirely located within your local government's jurisdiction? ☐ (not selected) ☒ Yes ☐ No

If no, in what additional jurisdictions is the project located?

Is the current proposal a continuation or expansion of a previous DRI? ☐ (not selected) ☒ Yes ☐ No

If yes, provide the following information: Project Name: Accolades at Stonewall Tell
Project ID: 164

The initial action being requested of the local government for this project: ☐ Rezoning
☐ Variance
☐ Sewer
☐ Water
☒ Permit
☐ Other

Is this project a phase or part of a larger overall project? ☐ (not selected) ☐ Yes ☒ No

If yes, what percent of the overall project does this project/phase represent?

Estimated Project Completion Dates: This project/phase: 06/15/2020
Overall project: 06/15/2020

[Back to Top](#)

[GRTA DRI Page](#) | [ARC DRI Page](#) | [RC Links](#) | [DCA DRI Page](#) | [Site Map](#) | [Statements](#) | [Contact](#)



Developments of Regional Impact

[DRI Home](#)
[Tier Map](#)
[Apply](#)
[View Submissions](#)
[Login](#)

DRI #2745

DEVELOPMENT OF REGIONAL IMPACT Additional DRI Information

This form is to be completed by the city or county government to provide information needed by the RDC for its review of the proposed DRI. Refer to both the [Rules for the DRI Process](#) and the [DRI Tiers and Thresholds](#) for more information.

Local Government Information

Submitting Local Government: Union City
Individual completing form: Ellis Still
Telephone: 770-515-7955
Email: estill@unioncityga.org

Project Information

Name of Proposed Project: South Fulton Parkway at Stonewall Tell
DRI ID Number: 2745
Developer/Applicant: Majestic Realty Co.
Telephone: 404-467-5261
Email(s): sbrown@majesticrealty.com

Additional Information Requested

Has the RDC identified any additional information required in order to proceed with the official regional review process? (If no, proceed to Economic Impacts.)
☐ (not selected) ☒ Yes ☐ No

If yes, has that additional information been provided to your RDC and, if applicable, GRTA?
☐ (not selected) ☒ Yes ☐ No

If no, the official review process can not start until this additional information is provided.

Economic Development

Estimated Value at Build-Out: 95,000,000

Estimated annual local tax revenues (i.e., property tax, sales tax) likely to be generated by the proposed development: 1,100,000

Is the regional work force sufficient to fill the demand created by the proposed project?
☐ (not selected) ☒ Yes ☐ No

Will this development displace any existing uses?
☐ (not selected) ☒ Yes ☐ No

If yes, please describe (including number of units, square feet, etc):

Water Supply

Name of water supply provider for this site: City of Atlanta

What is the estimated water supply demand to be generated by the project, measured in Millions of Gallons Per Day (MGD)?

0.2 MGD

Is sufficient water supply capacity available to serve the proposed project?

☐ (not selected) ☒ Yes ☐ No

If no, describe any plans to expand the existing water supply capacity:

Is a water line extension required to serve this project?

☐ (not selected) ☐ Yes ☒ No

If yes, how much additional line (in miles) will be required?

Wastewater Disposal

Name of wastewater treatment provider for this site:

Fulton County

What is the estimated sewage flow to be generated by the project, measured in Millions of Gallons Per Day (MGD)?

0.16MGPD

Is sufficient wastewater treatment capacity available to serve this proposed project?

☐ (not selected) ☒ Yes ☐ No

If no, describe any plans to expand existing wastewater treatment capacity:

Is a sewer line extension required to serve this project?

☐ (not selected) ☐ Yes ☒ No

If yes, how much additional line (in miles) will be required?

Land Transportation

How much traffic volume is expected to be generated by the proposed development, in peak hour vehicle trips per day? (If only an alternative measure of volume is available, please provide.)

4,472 daily trips, per traffic study; 389 AM peak hour trips; 362 PM peak hour trips

Has a traffic study been performed to determine whether or not transportation or access improvements will be needed to serve this project?

☐ (not selected) ☒ Yes ☐ No

Are transportation improvements needed to serve this project?

☐ (not selected) ☒ Yes ☐ No

If yes, please describe below: Please refer to traffic study performed by Kimley-Horn and Associates, Inc.

Solid Waste Disposal

How much solid waste is the project expected to generate annually (in tons)?

1,900 tons

Is sufficient landfill capacity available to serve this proposed project?

☐ (not selected) ☒ Yes ☐ No

If no, describe any plans to expand existing landfill capacity:

Will any hazardous waste be generated by the development?

☐ (not selected) ☐ Yes ☒ No

If yes, please explain:

Stormwater Management

What percentage of the site is projected to be impervious surface once the proposed development has been constructed?

50 -60%

Describe any measures proposed (such as buffers, detention or retention ponds, pervious parking areas) to mitigate the project's impacts on stormwater management: Comply with City and County's stormwater ordinance and development regulations.

Environmental Quality

Is the development located within, or likely to affect any of the following:

1. Water supply watersheds? ☐ (not selected) ☐ Yes ☒ No
2. Significant groundwater recharge areas? ☐ (not selected) ☐ Yes ☒ No
3. Wetlands? ☐ (not selected) ☐ Yes ☒ No
4. Protected mountains? ☐ (not selected) ☐ Yes ☒ No
5. Protected river corridors? ☐ (not selected) ☐ Yes ☒ No
6. Floodplains? ☐ (not selected) ☐ Yes ☒ No
7. Historic resources? ☐ (not selected) ☐ Yes ☒ No
8. Other environmentally sensitive resources? ☐ (not selected) ☐ Yes ☒ No

If you answered yes to any question above, describe how the identified resource(s) may be affected:

[Back to Top](#)

[GRTA DRI Page](#) | [ARC DRI Page](#) | [RC Links](#) | [DCA DRI Page](#) | [Site Map](#) | [Statements](#) | [Contact](#)

L:\2016\201610170 Preliminary\201610170 - DRI.dwg, 4000 FULL BLEED 0 (8.60 x 24.00 INCHES), SOURCE: PLOTTER, DWG TO PDF, PCL, A000, January 22, 2016 8:04:27 PM

PRELIMINARY SITE PLAN DISCLAIMER:

SITE PLAN IS BASED ON CLIENT PROVIDED INFORMATION POSSIBLY INCLUDING BUT NOT LIMITED TO THE FOLLOWING: TAX MAPS, USGS MAPS, GIS INFORMATION, SCANNED/DIGITAL BOUNDARY SURVEY, SCANNED/DIGITAL TOPOGRAPHICAL SURVEY, SCANNED/DIGITAL AS-BUILT PLAN, SCANNED/DIGITAL ALTA SURVEY, AND/OR PREVIOUS CONSTRUCTION PLANS BY PM/OTHERS. ALL ZONING INFORMATION SHOWN IN THE TITLEBLOCK TO THE RIGHT HAS BEEN RESEARCHED BUT NOT VERIFIED WITH THE JURISDICTION.

SITE PLAN BOUNDARY AND EXISTING CONDITIONS ARE ONLY AS ACCURATE AS THE INFORMATION PROVIDED.

CONTACT INFORMATION:

TRAFFIC ENGINEER:
KIMLEY-HORN AND ASSOCIATES, INC.
11720 AMBER PARK DRIVE, SUITE 600,
ALPHARETTA, GA 30009

CONTACT:
JOHN WALKER, PE
470.273.3181

DEVELOPER CONTACT:
GARY WAX
678.300.7056

MAJESTIC REALTY COMPANY
3490 PIEDMONT ROAD NE, SUITE 210
ATLANTA, GA 30305

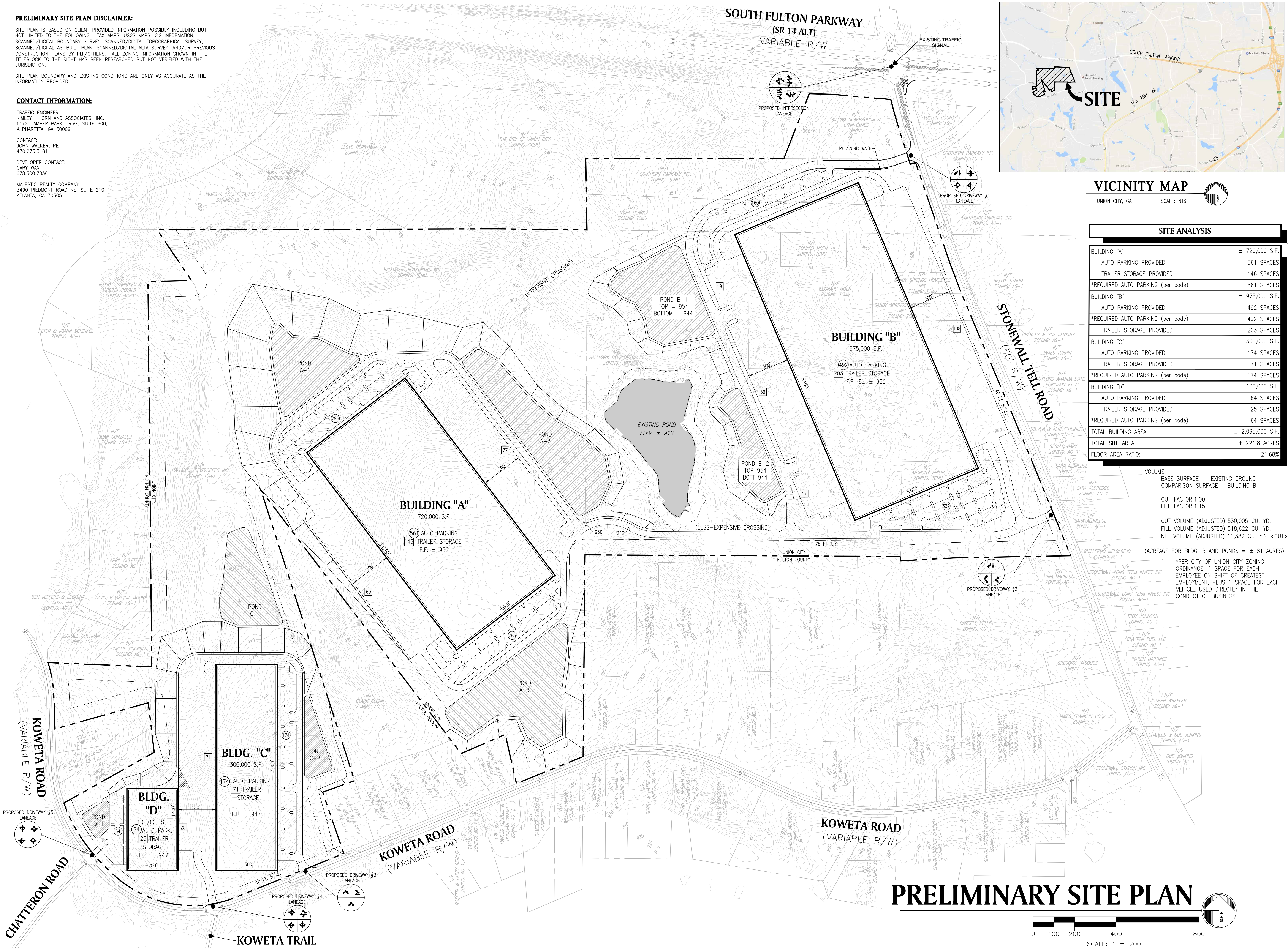

LAND PLANNERS
ENGINEERS • SURVEYORS
TRANSPORTATION
LANDSCAPE ARCHITECTS

85-A MILL STREET
SUITE 200
ROSWELL, GEORGIA 30075
VOICE 770.650.7685
FAX 770.650.7684
www.paulsonmitchell.com

PAULSON MITCHELL
INCORPORATED

PROJECT:
SOUTH FULTON PARKWAY AT STONEMALL TELL DRI #2745

STONEMALL TELL ROAD
SOUTH OF S. FULTON PARKWAY
UNION CITY, GA 30349

FOR:
MAJESTIC REALTY COMPANY
One Securities Centre
3490 Piedmont Road NE, Suite 210
Atlanta, GA 30305
(404) 467-5255

ZONING INFORMATION
ZONING RESEARCH DATE: JANUARY, 2017

ZONING CLASSIFICATION
JURISDICTION: UNION CITY, GA
EX. ZONING: TCMU (TOWN CTR. MIXED USE)
PR. ZONING: TCMU (TOWN CTR. MIXED USE)

BUILDING SETBACKS
FRONT: 15'
SIDE: 10'
REAR: 20'

BUFFERS
FRONT/STREET: 10' L.S.
SIDE: 75' L.S.
REAR: 75' L.S.

BUILDING SUMMARY (TCMU)
MAX. BUILDING HT.: --
MAX. BUILDING COVERAGE: --

PARKING SUMMARY
RETAIL REQ.: --
INDUSTRIAL REQ.: 1 SPACE/EMPLOYEE
STANDARD STALL DIMENSIONS: 8'-6" x 18'
COMPACT STALL DIMENSIONS: --' x --'
COMPACT STALLS ALLOWED: --%
MIN. 90'/60' DRIVE WIDTH: 24'/18'

LANDSCAPE REGULATIONS
TREE DENSITY: -- UNITS/ACRE
ISLAND REQ.: 1 ISLAND/10 SPACES
MIN. ISLAND SIZE/WIDTH: 25 S.F./5'
GREENSPACE %: --

FEMA MAP
FIRM PANEL #: 13121C0452F & 13121C0456F

DRAWING RECORD
DRAWN BY: 2016107 - DRI.dwg 12.04.17
01.22.18

PRELIMINARY SITE PLAN

SHEET **DRI**